

Township 6N Range 35E W.M.

Sec. 26 North

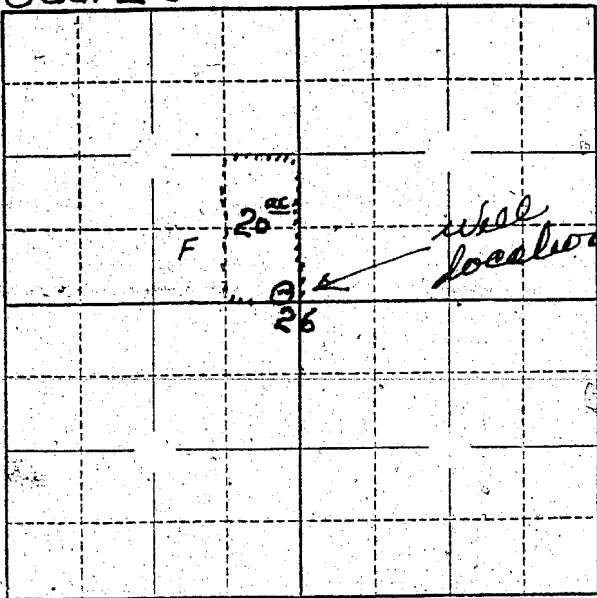

Locate well and acreage of irrigated land on plat.

Scale ~~1/4~~ = 1 Mile
1" = 1 M.

STATE OF OREGON

County of Umatilla } ss.

I, John Wesley Bailey, being first duly sworn, do hereby certify that I have read the foregoing Registration Statement and that all of the items therein contained are true to the best of my knowledge and belief.

John Wesley Bailey
(Signature of Registrant)

Subscribed and sworn to before me this 30th day of July, 1958

My commission expires Jan. 26, 1962
S. B. Bishop (Notary Public)

(SEAL)

CERTIFICATE OF REGISTRATION

STATE OF OREGON } ss.
County of Marion

This is to certify that the foregoing Registration Statement was received in the office of the State Engineer on the 1st day of August, 1958, at 1:00 o'clock P.M. and has been duly recorded in said office in Book No. 15 of Registration Statements on page GR-3509

Witness my hand this 15th day of September, 1959
Stewart A. Stanley
(State Engineer)

By _____ (Deputy)

\$15.00

GR 3509