

Township 6N Range 35E, W.M.
North

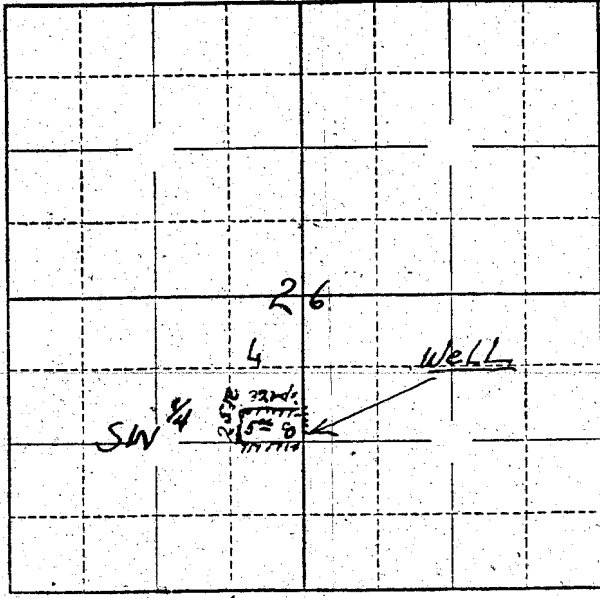

Locate well and acreage of irrigated land on plat.
Scale: $\frac{1}{4}$ " = 1 Mile
 $\frac{1}{2}$ " = 1 Mile

STATE OF OREGON }
County of Wematilla } ss.

I, Chas. Halden, being first duly sworn, do hereby certify that I have read the foregoing Registration Statement and that all of the items therein contained are true to the best of my knowledge and belief.

Chas. Halden
(Signature of Registrant)

Subscribed and sworn to before me this 31st day of Sept, 1959

My commission expires October 6, 1960
H. Rodde
(Notary Public for Oregon)

(SEAL)

CERTIFICATE OF REGISTRATION

STATE OF OREGON }
County of Marion } ss.

This is to certify that the foregoing Registration Statement was received in the office of the State Engineer on the 1st day of August, 1959, at 1:00 o'clock P.M. and has been duly recorded in said office in Book No. 15 of Registration Statements on page GR-3511

Witness my hand this 15th day of September, 1959

W. A. Stanley
(State Engineer)

By _____
(Deputy)

\$ 15.00