

Township 5 N Range 2 W W.M.

North

Well

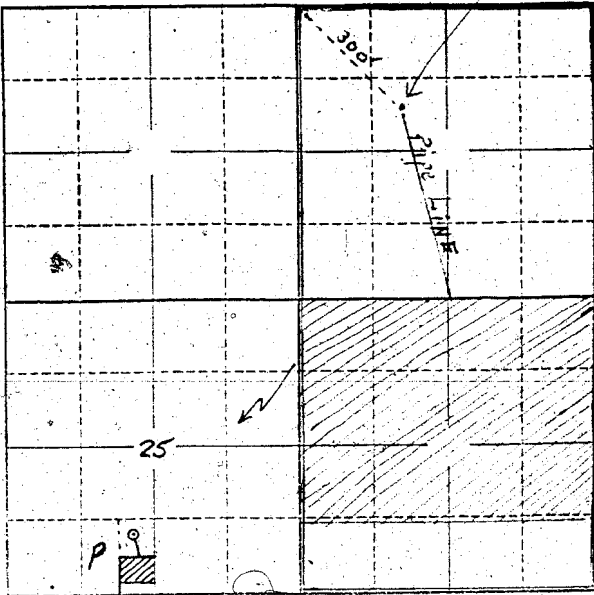

E 1/2 SE 1/4 SW 1/4
Sec. 25
T 5 N, R 2 W

Locate well and acreage of irrigated land on plat.

Scale: 2" = 1 Mile

STATE OF OREGON

County of Columbia

ss.

I, Emit A. Martin, being first duly sworn, do hereby certify that I have read the foregoing Registration Statement and that all of the items therein contained are true to the best of my knowledge and belief.

Emit Martin
(Signature of Registrant)

Subscribed and sworn to before me this 31 day of July, 1958

My commission expires January 25-1961

Jay Martin
(Notary Public)

(SEAL)

CERTIFICATE OF REGISTRATION

STATE OF OREGON

County of Marion

This is to certify that the foregoing Registration Statement was received in the office of the State Engineer on the 15 day of August, 1958, at 8:00 o'clock A. M. and has been duly recorded in said office in Book No. 15 of Registration Statements on page GR-3553

~~Construction shall be completed by 1959 and the water completely applied to beneficial use by 1959~~

Witness my hand this 15th day of September, 1959

Mura A. Stanley
(State Engineer)

By

(Deputy)

GR-3553

\$15.00