

Township 17 S Range 3 W W.M.
North

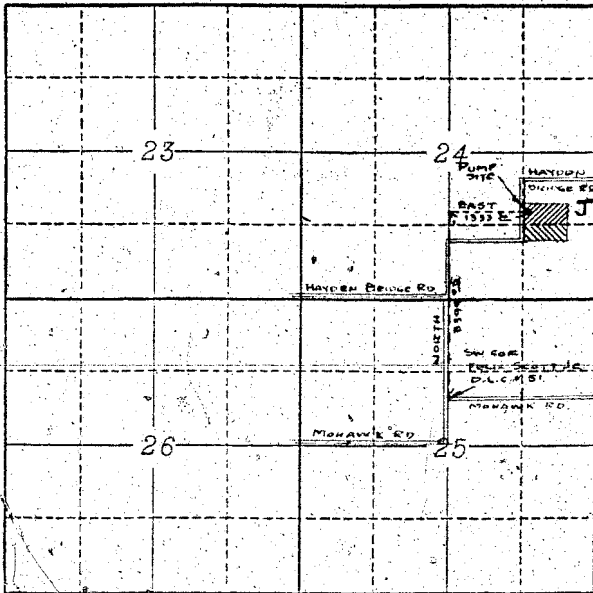

Locate well and acreage of irrigated land on plat.

Scale: 2" = 1 Mile

STATE OF OREGON

County of LANE } ss.

I, FRANK BARTHOLOMEW, being first duly sworn, do hereby certify that I have read the foregoing Registration Statement and that all of the items therein contained are true to the best of my knowledge and belief.

Frank W. Bartholomew
(Signature of Registrant)

Subscribed and sworn to before me this 1st day of AUGUST, 19 58.

My commission expires AUGUST 23, 1960. *A. Margaret Hutchinson*
(Notary Public)

(SEAL)

CERTIFICATE OF REGISTRATION

STATE OF OREGON }
County of Marion } ss.

This is to certify that the foregoing Registration Statement was received in the office of the State Engineer on the 4th day of August, 19 58, at 8:00 o'clock A. M. and has been duly recorded in said office in Book No. 15 of Registration Statements on page GR-3556

Witness my hand this 15th day of September, 19 59.

Clara A. Stanley
(State Engineer)

By _____ (Deputy)

\$ 15.00

GR 3556