

Township 7S Range 2W, W.M.
North

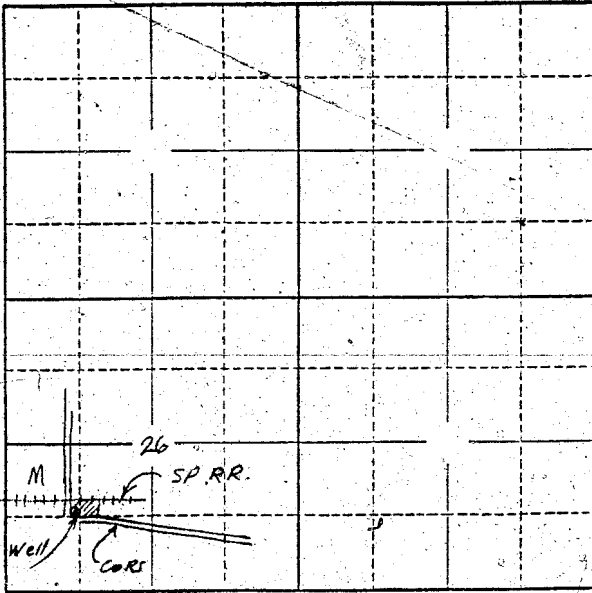

Locate well and acreage of irrigated land on plat.
Scale: 2" = 1 Mile

STATE OF OREGON

County of Marion } ss.

I, Clyde M Johnson, being first duly sworn, do hereby certify that I have read the foregoing Registration Statement and that all of the items therein contained are true to the best of my knowledge and belief.

Clyde M Johnson
(Signature of Registrant)

Subscribed and sworn to before me this 4th day of August, 1958

My commission expires 12th June 1961 Wm. S. Bartholomew
(Notary Public)

(SEAL)

CERTIFICATE OF REGISTRATION

STATE OF OREGON }
County of Marion } ss.

This is to certify that the foregoing Registration Statement was received in the office of the State Engineer on the 4th day of August, 1958, at 12⁰⁰ o'clock A.M. and has been duly recorded in said office in Book No. 15 of Registration Statements on page GR-3561

Witness my hand this 15th day of September, 1959

Lewis A. Stanley
(State Engineer)

By _____
(Deputy)

\$15.00