

Township 25 Range 1W, W.M.
North

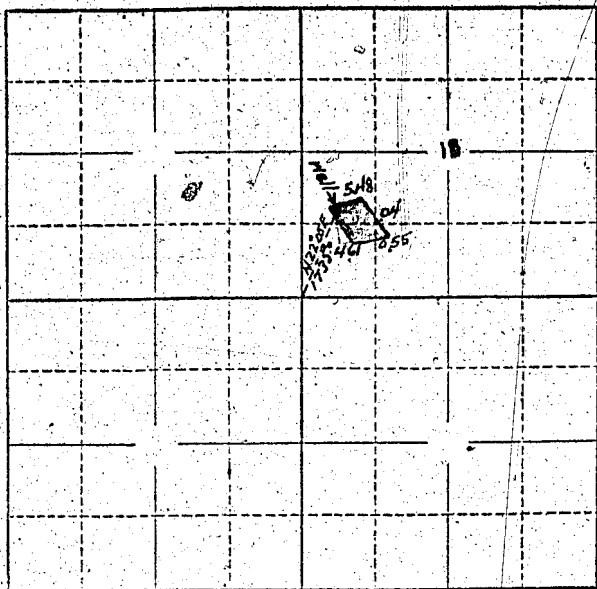

Locate well and acreage of irrigated land on plat.

Scale: 2" = 1 Mile

STATE OF OREGON

County of Marion } ss.

I, Leon Hilton, being first duly sworn, do hereby certify that I have read the foregoing Registration Statement and that all of the items therein contained are true to the best of my knowledge and belief.

Leon Hilton
(Signature of Registrant)

Subscribed and sworn to before me this 12 day of March, 1957

My commission expires 8/21/58

Norman Lee
(Notary Public)

(SEAL)

CERTIFICATE OF REGISTRATION

STATE OF OREGON

County of Marion } ss.

This is to certify that the foregoing Registration Statement was received in the office of the State Engineer on the 15th day of March, 1957, at 8:00 o'clock A.M. and has been duly recorded in said office in Book No. 3 of Registration Statements on page GR-362 C.

~~Construction shall be completed by X-X-X-X-X-X-X-X-18-X-X and the water completely applied to artificial use by X-X-X-X-X-X-X-X-18-X-X~~

Witness my hand this 23rd day of May, 1957

Lewis A. Stanley
(State Engineer)

By _____ (Deputy)

\$15.00