

Township 17S Range 4W, W.M.
North

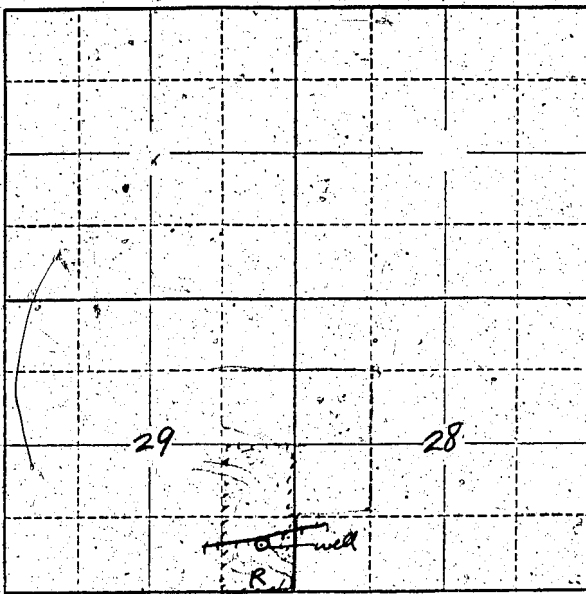

Locate well and acreage of irrigated land on plat.
Scale: 2" = 1 Mile

STATE OF OREGON

County of LANE, } ss.

I, Clair J. Deartz, being first duly sworn, do hereby certify that I have read the foregoing Registration Statement and that all of the items therein contained are true to the best of my knowledge and belief.

Clair J. Deartz
(Signature of Registrant)

Subscribed and sworn to before me this 2nd day of August, 1955

My commission expires 1/26/62 W. W. Buntle
(Notary Public)

(SEAL)

CERTIFICATE OF REGISTRATION

STATE OF OREGON } ss.
County of Marion

This is to certify that the foregoing Registration Statement was received in the office of the State Engineer on the 4th day of August, 1956 at 2:00 o'clock A. M. and has been duly recorded in said office in Book No. 17 of Registration Statements on page GR-4094

Witness my hand this 14th day of July, 1960

Lewis A. Stanley
(State Engineer)

By _____
(Deputy)

GR 4094

1965