

Sec 18

Township 1 S Range 2 W, W.M. North

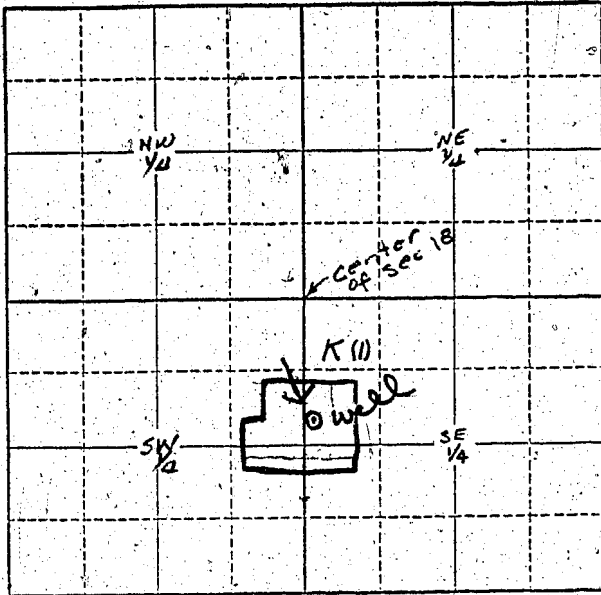

Co. Engineer made these notations 18.3 acre is in part of 4 different quarters in each 1/4 pretty hard to figure out.

Locate well and acreage of irrigated land on plat.

Scale: 2" = 1 Mile

STATE OF OREGON }  
County of Washington } ss.

I, Floyd D. Edmiston, being first duly sworn, do hereby certify that I have read the foregoing Registration Statement and that all of the items therein contained are true to the best of my knowledge and belief.

Floyd D. Edmiston  
(Signature of Registrant)

Subscribed and sworn to before me this 15<sup>th</sup> day of March, 1957

My commission expires 10/7/60

Harold Davis  
(Notary Public)

(SEAL)

**CERTIFICATE OF REGISTRATION**

STATE OF OREGON }  
County of Marion } ss.

This is to certify that the foregoing Registration Statement was received in the office of the State Engineer on the 18th day of March, 1957, at 8:00 o'clock A. M. and has been duly recorded in said office in Book No. 3 of Registration Statements on page GR-513 C

~~Construction shall be completed by X-X-X-X-X-X-X-X, 19-X-X, and the water completed by X-X-X-X-X-X-X-X by X-X-X-X-X-X-X-X, 19-X-X-X~~

Witness my hand this 24th day of July, 1957

Lewis A. Stanley  
(State Engineer)

\$1500

By \_\_\_\_\_ (Deputy)