

Township 17 S Range 3 W, W.M.
North

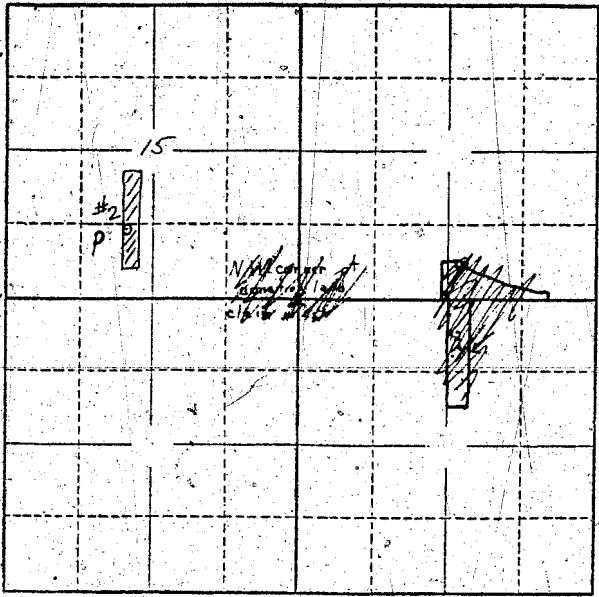

Locate well and acreage of irrigated land on plat.
Scale: 2" = 1 Mile

STATE OF OREGON }
County of Marion } ss.

I, [Signature], being first duly sworn, do hereby certify that I have read the foregoing Registration Statement and that all of the items therein contained are true to the best of my knowledge and belief.

[Signature]
(Signature of Registrant)

Subscribed and sworn to before me this 15 day of September, 1959.

My commission expires MY COMMISSION EXPIRES DECEMBER 31 1961 [Signature]
(Notary Public)

(SEAL)

CERTIFICATE OF REGISTRATION

STATE OF OREGON }
County of Marion } ss.

This is to certify that the foregoing Registration Statement was received in the office of the State Engineer on the 4th day of August, 1958, at 2:00 o'clock A. M. and has been duly recorded in said office in Book No. 15 of Registration Statements on page GR-3615

Witness my hand this 15th day of September, 1959.

[Signature]
(State Engineer)

By _____
(Deputy)

#15.00