

Township 17S, Range 3W, W.M.  
North

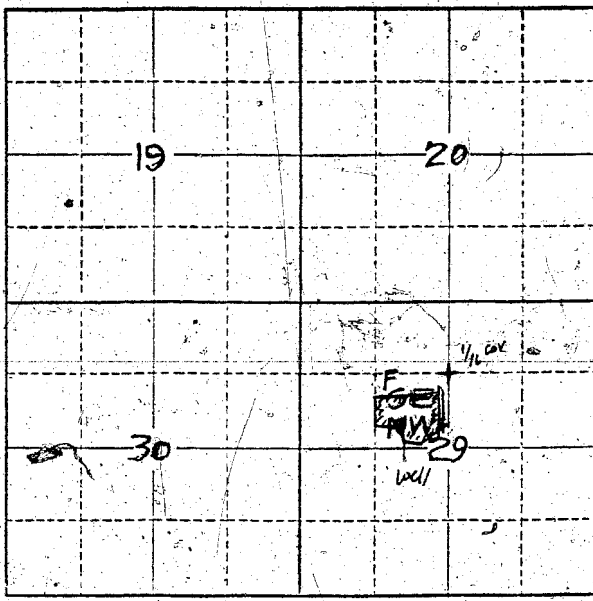

Locate well and acreage of irrigated land on plat.  
Scale: 2" = 1 Mile

STATE OF OREGON

County of Linn } ss.

I, WAYNE HAYES, being first duly sworn, do hereby certify that I have read the foregoing Registration Statement and that all of the items therein contained are true to the best of my knowledge and belief.

Wayne Hayes  
(Signature of Registrant)

Subscribed and sworn to before me this 1st day of August, 1957.

My commission expires CHARLES W. ROFFE

Charles W. Roffe  
(Notary Public)

My Commission Expires June 24, 1961

(SEAL)

**CERTIFICATE OF REGISTRATION**

STATE OF OREGON

County of Marion } ss.

This is to certify that the foregoing Registration Statement was received in the office of the State Engineer on the 4th day of August, 1957, at 2:00 o'clock P.M. and has been duly recorded in said office in Book No. 15 of Registration Statements on page GR-3621

Witness my hand this 15th day of September, 1959.

Lewis A. Stanley  
(State Engineer)

\$15.00

By \_\_\_\_\_  
(Deputy)