

See attached diagram.

Township 17S Range 3W, W.M.
North

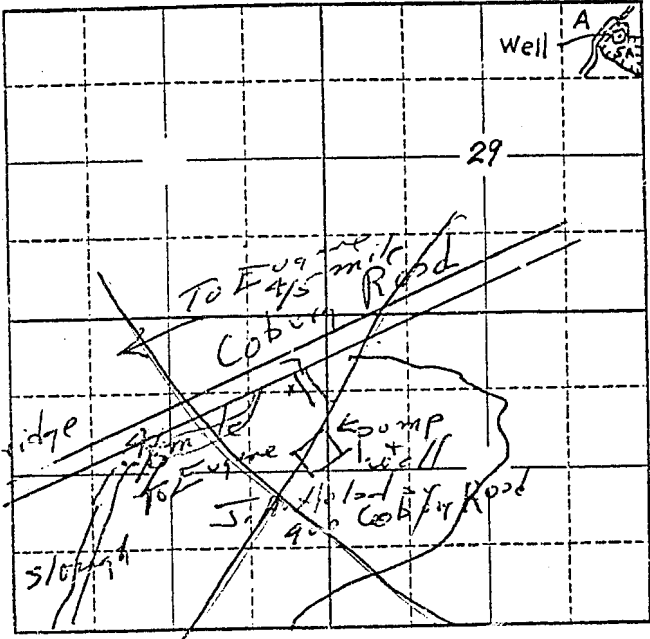

Locate well and acreage of irrigated land on plat.
Scale: 2" = 1 Mile

STATE OF OREGON }
County of Lane } ss.

I, Joseph A. Holaday, being first duly sworn, do hereby certify that I have read the foregoing Registration Statement and that all of the items therein contained are true to the best of my knowledge and belief.

Joseph A. Holaday
(Signature of Registrant)
Subscribed and sworn to before me this 1 day of August, 1958
[Signature]
(Notary Public)

My commission expires
My Commission Expires July 27, 1960
(SEAL)

CERTIFICATE OF REGISTRATION

STATE OF OREGON }
County of Marion } ss.

This is to certify that the foregoing Registration Statement was received in the office of the State Engineer on the 4th day of August, 1958, at 2:00 o'clock A.M. and has been duly recorded in said office in Book No. 17 of Registration Statements on page GR-4142

Witness my hand this 5th day of August, 1966
[Signature]
(State Engineer)

1,500

By
(Deputy)