

North

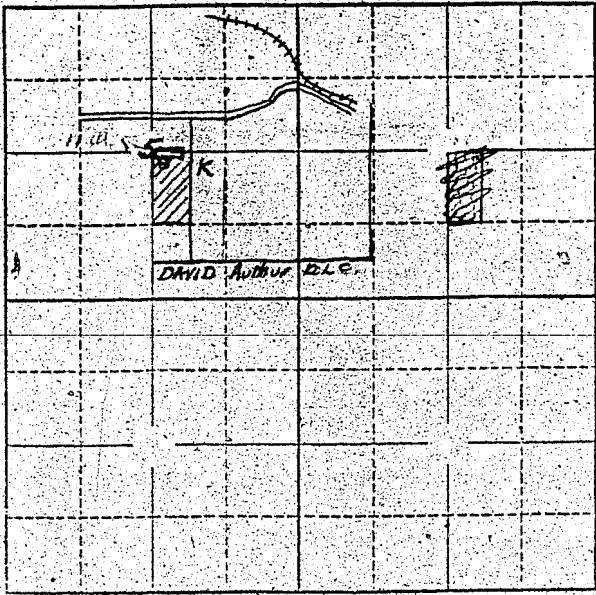

Locate well and acreage of irrigated land on plat.
Scale: 2" = 1 Mile

STATE OF OREGON

County of Lane } ss.

I, Eugene Chase, being first duly sworn, do hereby certify that I have read the foregoing Registration Statement and that all of the items therein contained are true to the best of my knowledge and belief.

Eugene Chase
(Signature of Registrant)

Subscribed and sworn to before me this 1st day of May, 1958

My commission expires My Commission Expires Aug. 25, 1959

Helmer L. Law
(Notary Public)

(SEAL)

CERTIFICATE OF REGISTRATION

STATE OF OREGON

County of Marion } ss.

This is to certify that the foregoing Registration Statement was received in the office of the State Engineer on the 15th day of August, 1958, at 8:00 o'clock A. M. and has been duly recorded in said office in Book No. 15 of Registration Statements on page GR-3640

~~XX Construction shall be completed on or before 1958 and the water completely applied to beneficial use by 1958. XX~~

Witness my hand this 15th day of September, 1959

Lewis A. Stanley
(State Engineer)

\$15.00

By GR-3640

(Deputy)