

Township 6N Range 35E, W.M.  
North

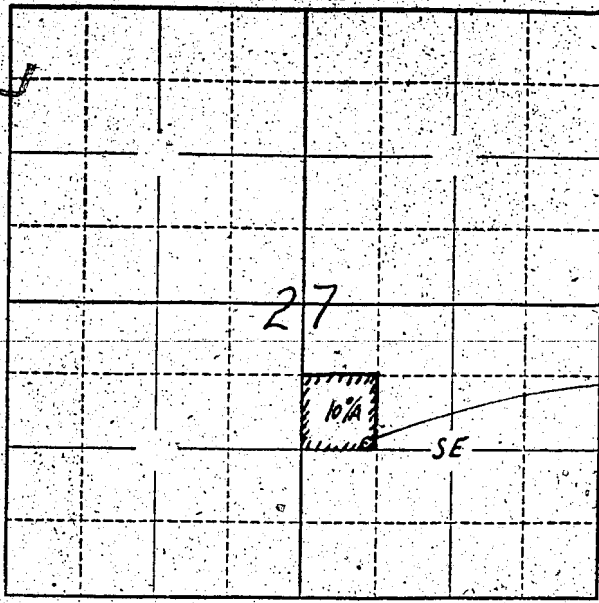

Well location  
1340' N x 650' E  
of S4 (corner of  
Sec. 27)

Locate well and acreage of irrigated land on plat.

Scale: 1/4 - 1 Mile

STATE OF OREGON

County of Umatilla } ss.

I, Kathryn LeFore, being first duly sworn, do hereby certify that I have read the foregoing Registration Statement and that all of the items therein contained are true to the best of my knowledge and belief.

X Kathryn LeFore  
(Signature of Registrant)

Subscribed and sworn to before me this 2nd day of August, 1958.

My commission expires October 6th, 1960.

D. K. Hasde  
(Notary Public) for Oregon

(SEAL)

**CERTIFICATE OF REGISTRATION**

STATE OF OREGON }  
County of Marion } ss.

This is to certify that the foregoing Registration Statement was received in the office of the State Engineer on the 4th day of August, 1958, at 2:00 o'clock A. M. and has been duly recorded in said office in Book No. 15 of Registration Statements on page GR-3667

Witness my hand this 20th day of October, 1959.

Henry A. Stanley  
(State Engineer)

By \_\_\_\_\_ (Deputy)

GR. 3667

\$15.00