

Township 6N Range 35E, W.M.
North

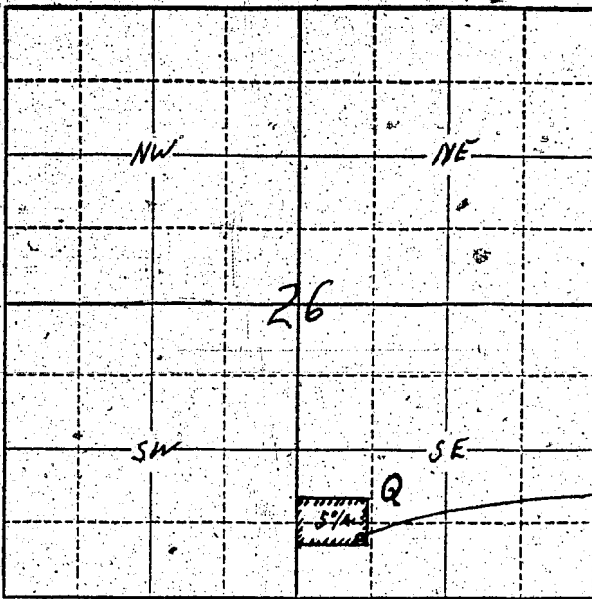

Well location
495' N + 633' E
of S⁴ Corner of
Sec 26

Locate well and acreage of irrigated land on plat.
Scale: $\frac{1}{4}$ - 1 Mile

STATE OF OREGON

County of Washington } ss.

I, Stanley P. W. Kennerly, being first duly sworn, do hereby certify that I have read the foregoing Registration Statement and that all of the items therein contained are true to the best of my knowledge and belief.

Stanley P. W. Kennerly
(Signature of Registrant)

Subscribed and sworn to before me this 17 day of August, 1958.

My commission expires 5-21-59 Stanley P. W. Kennerly
(Notary Public)

(SEAL)

CERTIFICATE OF REGISTRATION

STATE OF OREGON } ss.
County of Marion

This is to certify that the foregoing Registration Statement was received in the office of the State Engineer on the 4 day of August, 1958, at 8:00 o'clock A. M. and has been duly recorded in said office in Book No. 15 of Registration Statements on page GR-3669

Witness my hand this 20th day of October, 1959

Lewis A. Stanley
(State Engineer)

By _____
(Deputy)

\$15.00