

SW 1/4 Sec 35

Township 6N Range R 35E, W.M.

North

35

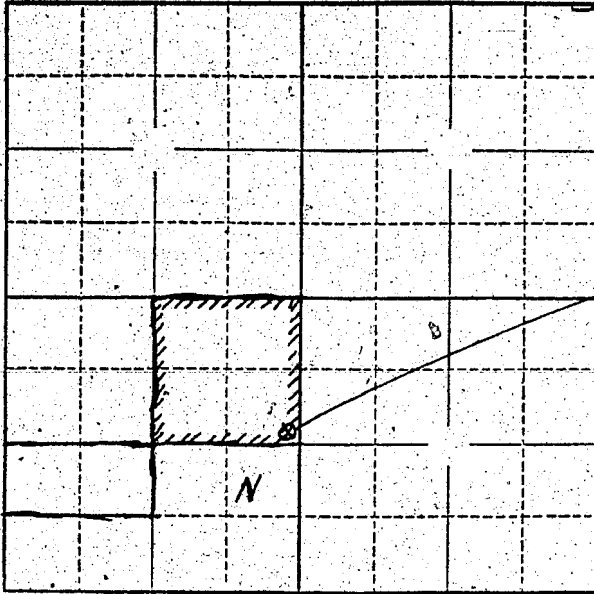

Well location
 650 FTS. 10' W
 NE CORNER SW 1/4
 SW 1/4 Sec 35
 T 6N R 35E

Locate well and acreage of irrigated land on plat.

Scale: 1" = 1 Mile
8"

STATE OF OREGON

County of Marion } ss.

I, Mrs Robert P. Pears, being first duly sworn, do hereby certify that I have read the foregoing Registration Statement and that all of the items therein contained are true to the best of my knowledge and belief.

Mrs Robert Pears
 (Signature of Registrant)

Subscribed and sworn to before me this 21 day of August, 1958.

My commission expires Jan 24, 1962
G. W. B. B. B.
 (Notary Public)

(SEAL)

CERTIFICATE OF REGISTRATION

STATE OF OREGON }
County of Marion } ss.

This is to certify that the foregoing Registration Statement was received in the office of the State Engineer on the 4th day of August, 1958, at 8:00 o'clock A.M. and has been duly recorded in said office in Book No. 15 of Registration Statements on page GR 3671

Witness my hand this 20th day of October, 1959

Lewis A. Stanley
 (State Engineer)

By _____ (Deputy)

\$ 15.00

GR 3671