

Township 16 S Range 4 W, W.M.

North

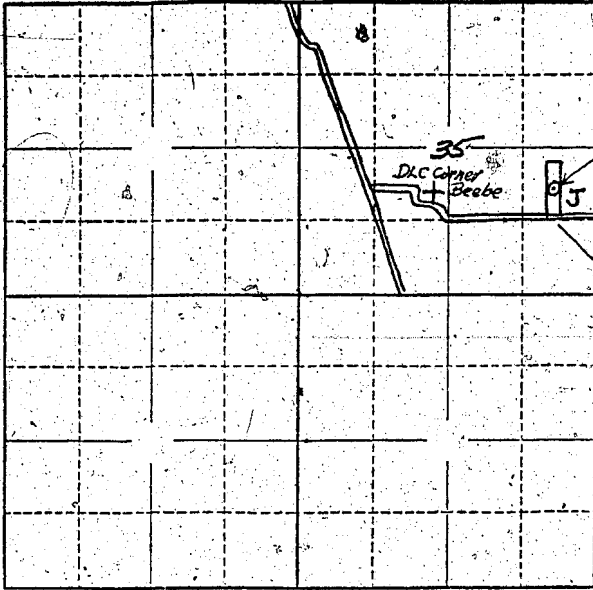

well
 208.3
 well
 acc of 6
 acc a
 irrigated
 approximately
 553,000 cu ft
 per year
 well is in center
 of land

Locate well and acreage of irrigated land on plat.

Scale: 2" = 1 Mile

STATE OF OREGON

County of Lane

} ss.

I, Edith K. Carr, being first duly sworn, do hereby certify that I have read the foregoing Registration Statement and that all of the items therein contained are true to the best of my knowledge and belief.

Edith K. Carr
 (Signature of Registrant)

Subscribed and sworn to before me this 2nd day of August, 1958.

My commission expires June 2, 1961

[Signature]
 (Notary Public)

(SEAL)

CERTIFICATE OF REGISTRATION

STATE OF OREGON

County of Marion

} ss.

This is to certify that the foregoing Registration Statement was received in the office of the State Engineer on the 4th day of August, 1957, at 2:00 o'clock P.M. and has been duly recorded in said office in Book No. 16 of Registration Statements on page GR-1020

Witness my hand this 11th day of April, 1960.

[Signature]
 (State Engineer)

By

(Deputy)

\$15.00

GR 4020