

Township 1N Range 1E W.M.
North

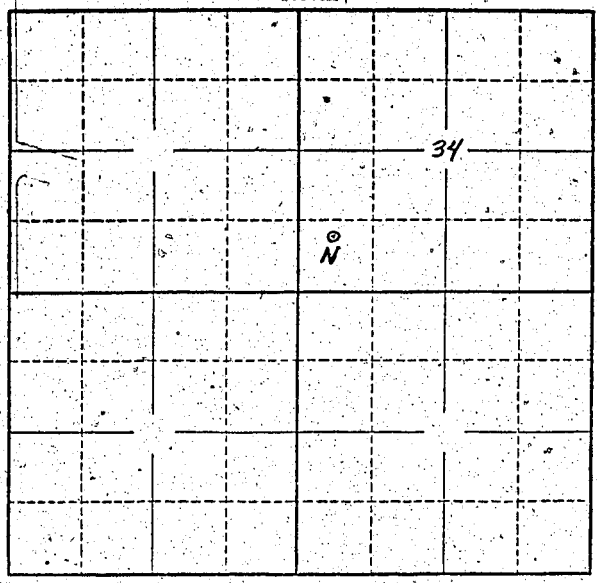

Locate well and acreage of irrigated land on plat.
Scale: 2" = 1 Mile

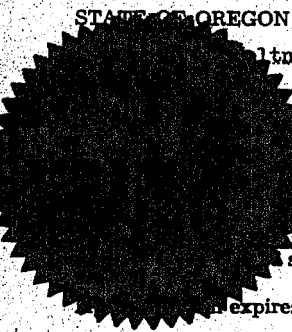

STATE OF OREGON } ss.
County of Marion

Randall being first duly sworn, do hereby certify that I have read the Registration Statement and that all of the items therein contained are true to the best of my knowledge.
of Portland Branch
Federal Reserve Bank of
San Francisco
Portland, Oregon

[Signature]
(Signature of Registrant) Vice President

sworn to before me this 1st day of August, 19 58

Registration expires 9/28/61

(SEAL)

[Signature]
N. P. for Oregon
(Notary Public)

CERTIFICATE OF REGISTRATION

STATE OF OREGON } ss.
County of Marion

This is to certify that the foregoing Registration Statement was received in the office of the State Engineer on the 4 day of August, 19 58, at 11 o'clock A.M. and has been duly recorded in said office in Book No. 9 of Registration Statements on page GR 1915

Witness my hand this 9th day of February, 19 59

[Signature]
(State Engineer)

By _____ (Deputy)

\$20.00