

Township 17S Range 1W W.M.

North

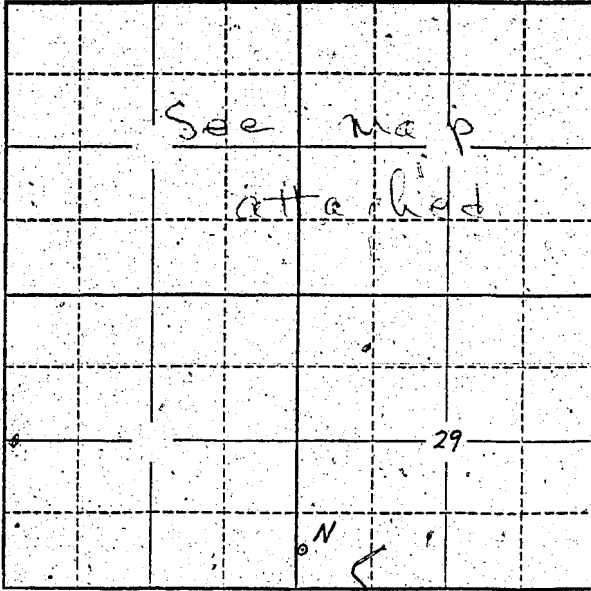

Locate well and acreage of irrigated land on plat.

Scale: 2" = 1 Mile

STATE OF OREGON

County of Marion } ss.

I, \_\_\_\_\_, being first duly sworn, do hereby certify that I have read the foregoing Registration Statement and that all of the items therein contained are true to the best of my knowledge and belief.

B. E. [Signature]  
(Signature of Registrant)

Subscribed and sworn to before me this 2 day of August, 1958

My commission expires NOTARY PUBLIC FOR OREGON  
(My Commission Expires Feb. 7, 1950)

[Signature]  
(Notary Public)

(SEAL)

**CERTIFICATE OF REGISTRATION**

STATE OF OREGON

County of Marion } ss.

This is to certify that the foregoing Registration Statement was received in the office of the State Engineer on the 4th day of August, 1958, at 8:00 o'clock A.M. and has been duly recorded in said office in Book No. 15 of Registration Statements on page OR-3687.

Witness my hand this 20th day of October, 1959

[Signature]  
(State Engineer)

By \_\_\_\_\_ (Deputy)

\$15.00