

Township 15s Range 4w W.M.
North

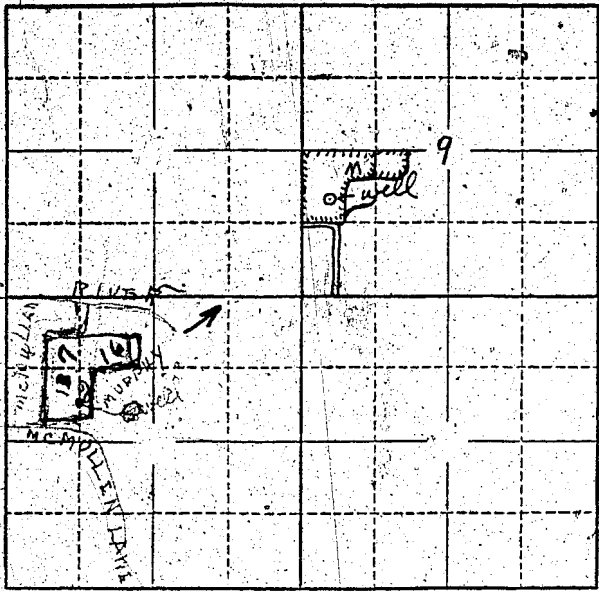

Locate well and acreage of irrigated land on plat.
Scale: 2" = 1 Mile

STATE OF OREGON }
County of Lane } ss.

I, Leon Bryson, being first duly sworn, do hereby certify that I have read the foregoing Registration Statement and that all of the items therein contained are true to the best of my knowledge and belief.

Leon Bryson
(Signature of Registrant)

Subscribed and sworn to before me this 2nd day of August, 1958.

My commission expires October 4, 1958

Thomas C. Tyle
(Notary Public)

(SEAL)

CERTIFICATE OF REGISTRATION

STATE OF OREGON }
County of Marion } ss.

This is to certify that the foregoing Registration Statement was received in the office of the State Engineer on the 4 day of August, 1958, at 8:00 o'clock A. M. and has been duly recorded in said office in Book No. 17 of Registration Statements on page GR-4054

Witness my hand this 16th day of May, 1960

Lawrence A. Stanley
(State Engineer)

By _____ (Deputy)

\$15.90