

Township 9S Range 3W W.M.
North

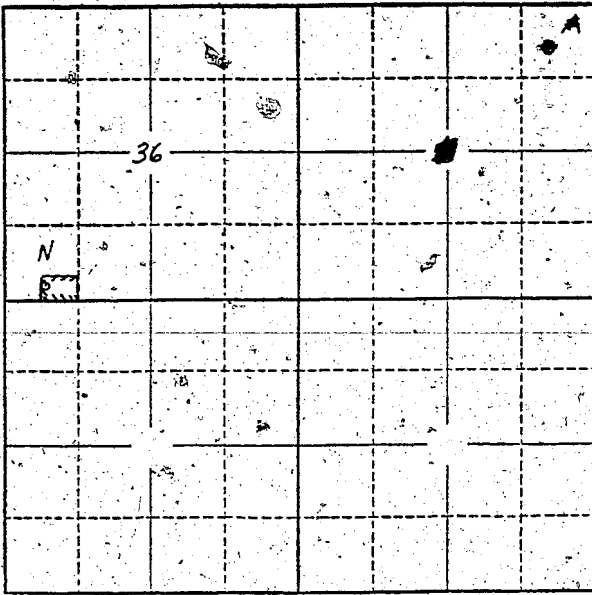

Locate well and acreage of irrigated land on plat.
Scale: 2" = 1 Mile

STATE OF OREGON

County of LINN } ss.

I, CLEO HINKHOUSE, being first duly sworn, do hereby certify that I have read the foregoing Registration Statement and that all of the items therein contained are true to the best of my knowledge and belief.

Cleo Hinkhouse
(Signature of Registrant)

Subscribed and sworn to before me this 1st day of August, 1958

My commission expires MY COMMISSION EXPIRES MAY 22, 1962

Lillian E. Phillips
(Notary Public)

(SEAL)

CERTIFICATE OF REGISTRATION

STATE OF OREGON

County of Marion } ss.

This is to certify that the foregoing Registration Statement was received in the office of the State Engineer on the 4th day of August, 1958, at 1:00 o'clock A. M. and has been duly recorded in said office in Book No. 15 of Registration Statements on page GR-3691.

Witness my hand this 20th day of October, 1959

W. A. Stanley
(State Engineer)

By _____
(Deputy)

GR 3691

\$ 15.00