

Township 15S Range 4W W.M.
North

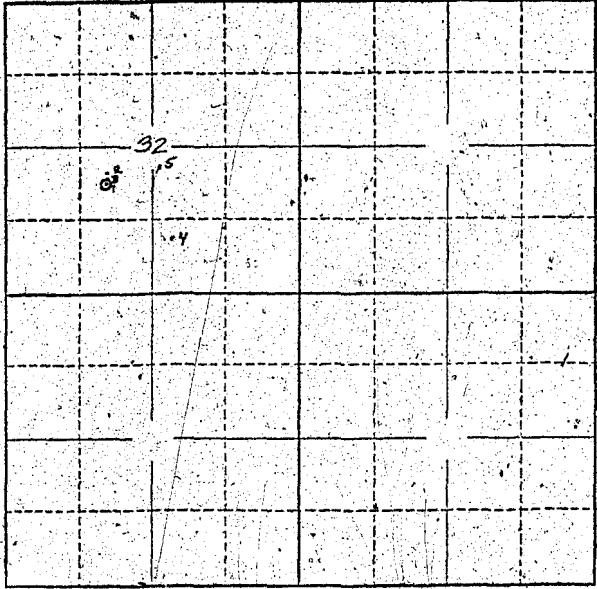

Locate well and acreage of irrigated land on plat.
Scale: 2" = 1 Mile

STATE OF OREGON }
County of Linn } ss.

I, Holger A. Jensen, Register, being first duly sworn, do hereby certify that I have read the foregoing Registration Statement and that all of the items therein contained are true to the best of my knowledge and belief.

Holger A. Jensen, Register
(Signature of Registrar)

Subscribed and sworn to before me this 3rd day of August, 1958

My commission expires April 11, 1960
Helmer Steinhilber
(Notary Public)

(SEAL)

CERTIFICATE OF REGISTRATION

STATE OF OREGON }
County of Marion } ss.

This is to certify that the foregoing Registration Statement was received in the office of the State Engineer on the 15th day of August, 1958, at 2:00 o'clock P. M. and has been duly recorded in said office in Book No. 16 of Registration Statements on page OR 3978

Witness my hand this 15th day of February, 1960

Lawrence A. Stanley
(State Engineer)



\$ 20⁰⁰

By _____ (Deputy)

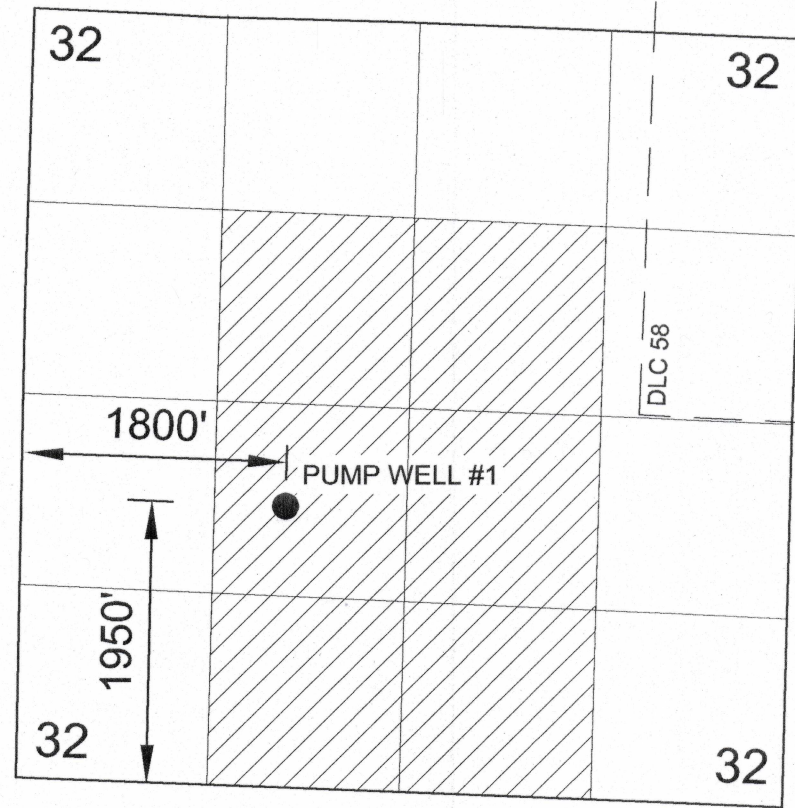
FROM LANDS

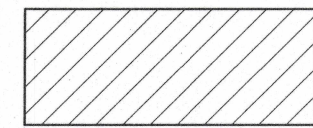

EXPLANATION

-  Authorized Place of Use
-  Authorized Point of Appropriation (Well)

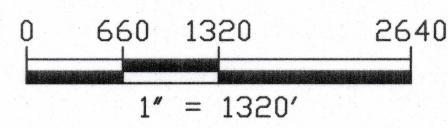

T15S, R4W, W.M.
SECTIONS 29, 30, 31, & 32

T15S, R5W, W.M.
SECTION 36





T16S, R4W, W.M.
SECTIONS 5, 6, 8, 17, 20, 21, & 29

LANE COUNTY

REGISTRATION No. GR-4122
CERTIFICATE No. GR-3978

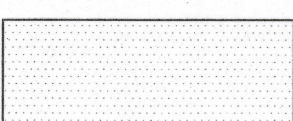
PRIORITY DATE: 1938

EXPLANATION

-  PROPOSED PLACE OF USE
-  URBAN GROWTH BOUNDARY
-  CITY LIMITS
-  PROPOSED POINT OF APPROPRIATION (WELL)
-  STORAGE TANK

TO LANDS

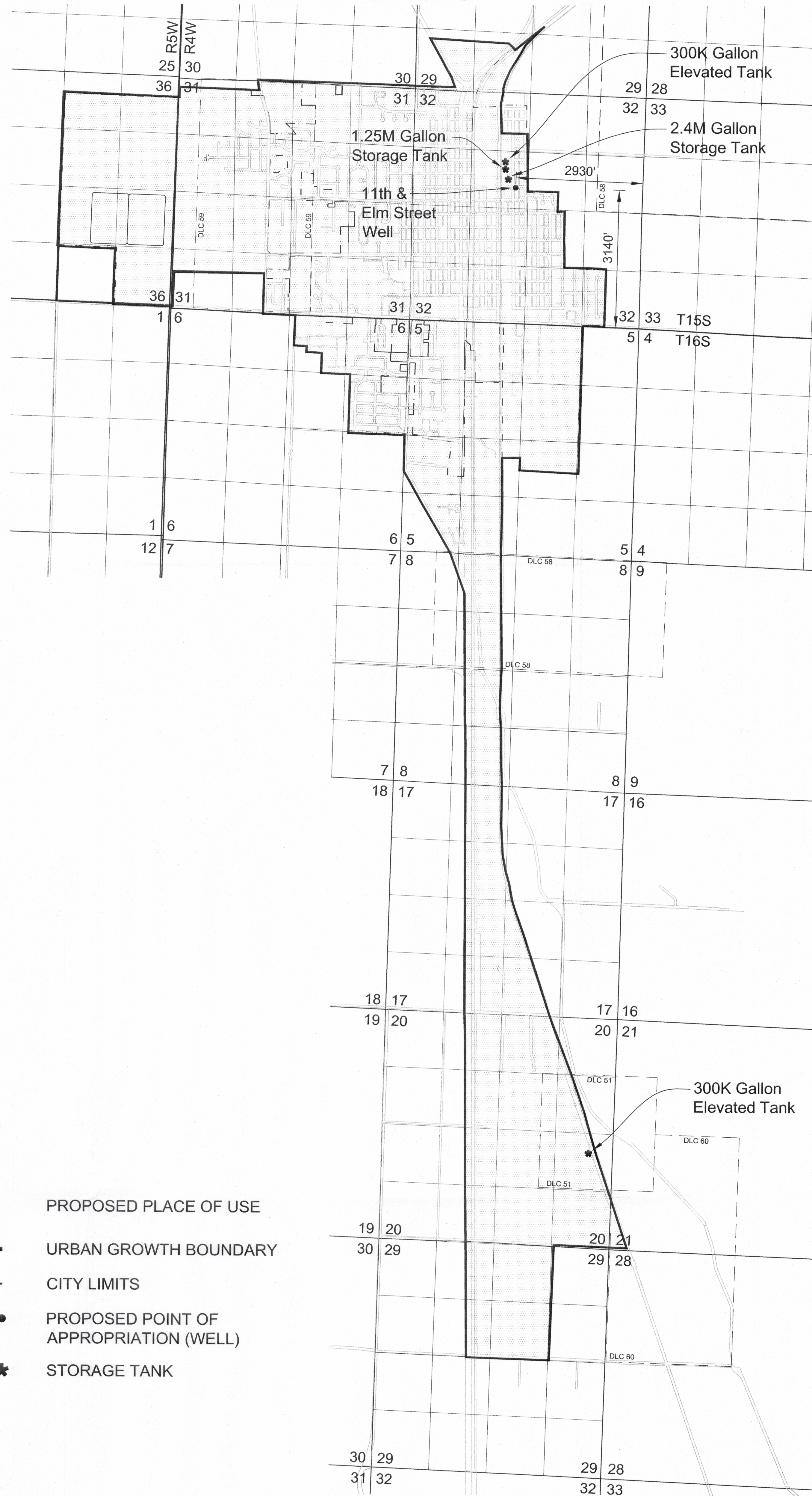

RECEIVED

AUG 04 2015

WATER RESOURCES DEPT
SALEM, OREGON

DISCLAIMER: THIS MAP IS NOT INTENDED TO PROVIDE
LEGAL DIMENSIONS OR LOCATIONS
OF PROPERTY OWNERSHIP LINES

APRIL 22, 2013

SKOOKUM
WATER ASSOCIATES INC

GROUNDWATER REGISTRATION MODIFICATION
JUNCTION CITY, OREGON

FIGURE 1

T 12126



4/22/2013 11:45:21 AM
C:\Users\jacob\Documents\City of 2013\Water Rights\9714151\Groundwater Registration Mods\figs (RMod 1.tbl)

T-12126

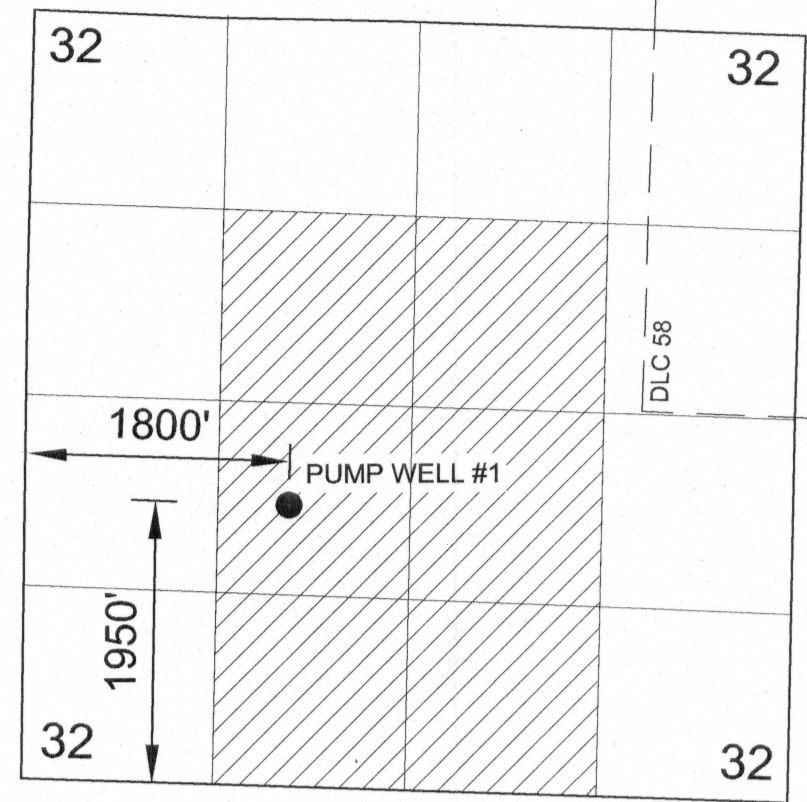
FROM LANDS

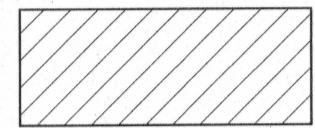

EXPLANATION

-  Authorized Place of Use
-  Authorized Point of Appropriation (Well)

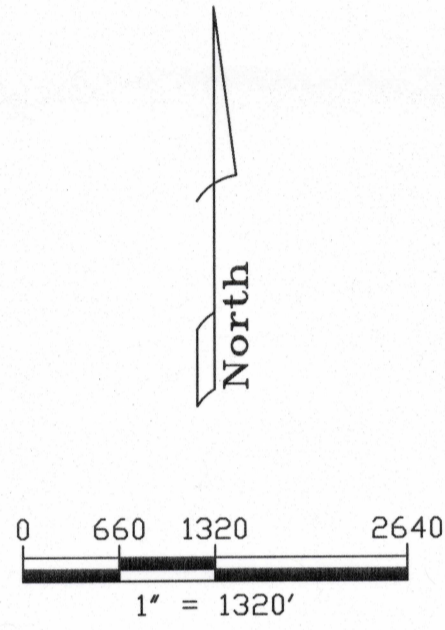

T15S, R4W, W.M.
SECTIONS 29, 30, 31, & 32

T15S, R5W, W.M.
SECTION 36





T16S, R4W, W.M.
SECTIONS 5, 6, 8, 17, 20, 21, & 29

LANE COUNTY

REGISTRATION No. GR-4122
CERTIFICATE No. GR-3978

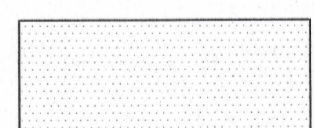
PRIORITY DATE: 1938

EXPLANATION

-  PROPOSED PLACE OF USE
-  URBAN GROWTH BOUNDARY
-  CITY LIMITS
-  PROPOSED POINT OF APPROPRIATION (WELL)
-  STORAGE TANK

TO LANDS

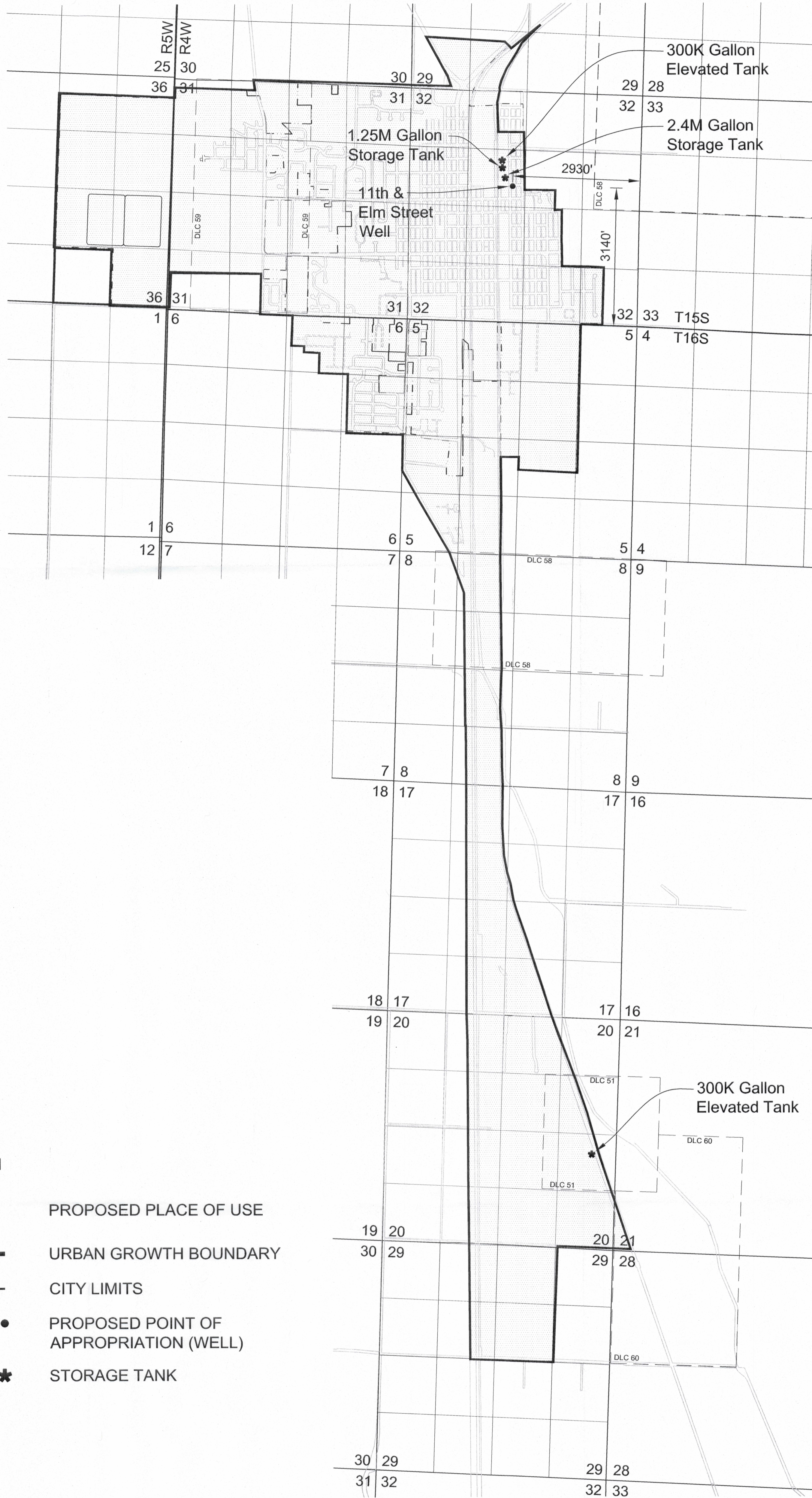

RECEIVED

AUG 04 2015

WATER RESOURCES DEPT
SALEM, OREGON

DISCLAIMER: THIS MAP IS NOT INTENDED TO PROVIDE
LEGAL DIMENSIONS OR LOCATIONS
OF PROPERTY OWNERSHIP LINES

APRIL 22, 2013

SKOOKUM
WATER ASSOCIATES INC

GROUNDWATER REGISTRATION MODIFICATION
JUNCTION CITY, OREGON

FIGURE 1

T 12126

4/22/2013 11:45:21 AM
S:\Data\City\City\2013\Water_Rights_971_4151\0\Conductor_Registration_Maps.dwg (08/04/15 1:18)

T-12126