

Township 4 N Range 1 W, W.M.
North

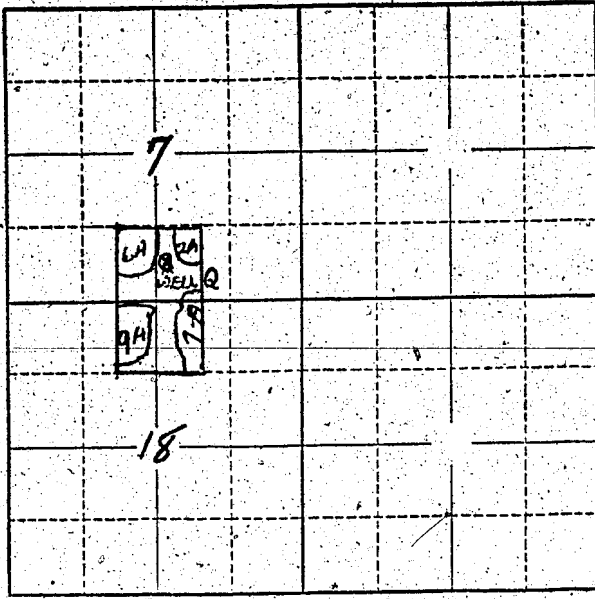

Locate well and acreage of irrigated land on plat.
Scale: 2" = 1 Mile

STATE OF OREGON

County of Columbia } ss.

I, OB Dick, being first duly sworn, do hereby certify that I have read the foregoing Registration Statement and that all of the items therein contained are true to the best of my knowledge and belief.

OB Dick
(Signature of Registrant)

Subscribed and sworn to before me this 1st day of August, 1958

NOTARY PUBLIC FOR OREGON

My commission expires _____

Dorothea Goldwell
(Notary Public)

(SEAL)

CERTIFICATE OF REGISTRATION

STATE OF OREGON } ss.
County of Marion

This is to certify that the foregoing Registration Statement was received in the office of the State Engineer on the 4th day of August, 1958, at 8:00 o'clock A.M. and has been duly recorded in said office in Book No. 15 of Registration Statements on page GR- 3714

Witness my hand this 20th day of October, 1959

Lewis A. Stanley
(State Engineer)

By _____ (Deputy)

GR 3714

15.00