

Township 2N Range 27E W.M.
North

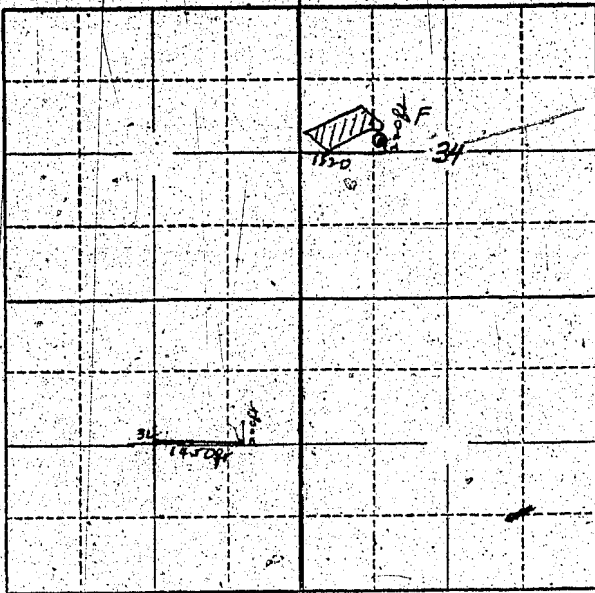

Locate well and acreage of irrigated land on plat.
Scale: 2" = 1 Mile

STATE OF OREGON

County of Umatilla } ss:

I, E. P. Doherty, being first duly sworn, do hereby certify that I have read the foregoing Registration Statement, and that all of the items therein contained are true to the best of my knowledge and belief.

E. P. Doherty
(Signature of Registrant)

Subscribed and sworn to before me this 21 day of July, 1958

My commission expires 3/24/62

Joseph Curran
(Notary Public)

(SEAL)

CERTIFICATE OF REGISTRATION

STATE OF OREGON

County of Marion } ss.

This is to certify that the foregoing Registration Statement was received in the office of the State Engineer on the 4 day of August, 1958, at 8:00 o'clock A.M. and has been duly recorded in said office in Book No. 17 of Registration Statements on page GR 4066

Witness my hand this 26 day of May, 1960

Lewis G. Stanley
(State Engineer)

By _____ (Deputy)