

North

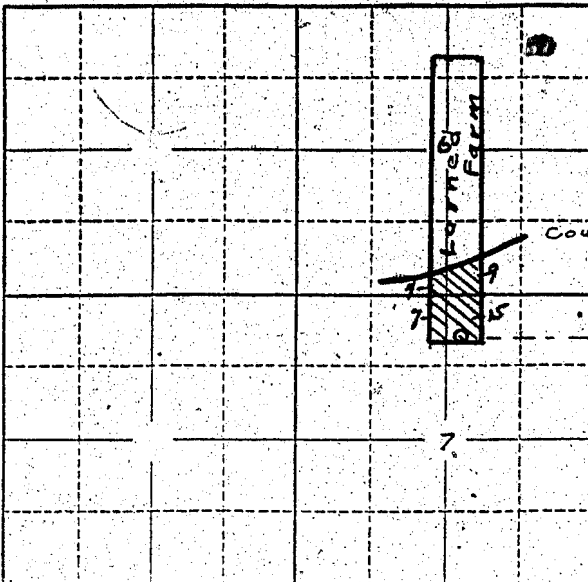

Flora S. ...

Locate well and acreage of irrigated land on plat.

Scale: 2" = 1 Mile

STATE OF OREGON

County of Benton } ss.

I, E E LARNED, being first duly sworn, do hereby certify that I have read the foregoing Registration Statement and that all of the items therein contained are true to the best of my knowledge and belief.

E E Larned

(Signature of Registrant)

Subscribed and sworn to before me this 15 day of March, 1957

My commission expires 1960 Commission Expires March 29, 1960

Anne D. Gaudet

(Notary Public)

(SEAL)

CERTIFICATE OF REGISTRATION

STATE OF OREGON } ss.
County of Marion

This is to certify that the foregoing Registration Statement was received in the office of the State Engineer on the 27th day of March, 1957, at 8:00 o'clock A. M. and has been duly recorded in said office in Book No. 3 of Registration Statements on page GR-398 C.

~~Construction shall be completed by x-x-x-x-x-x-x-x-x-x-x-x-x-x, and the water completely applied to~~
~~the x-x-x-x-x-x-x-x-x-x-x-x-x-x~~

Witness my hand this 23rd day of May, 1957

Lewis A. Stanley

(State Engineer)

By _____ (Deputy)

\$ 15.25