

Township 11 S Range 5 W, W.M.
North

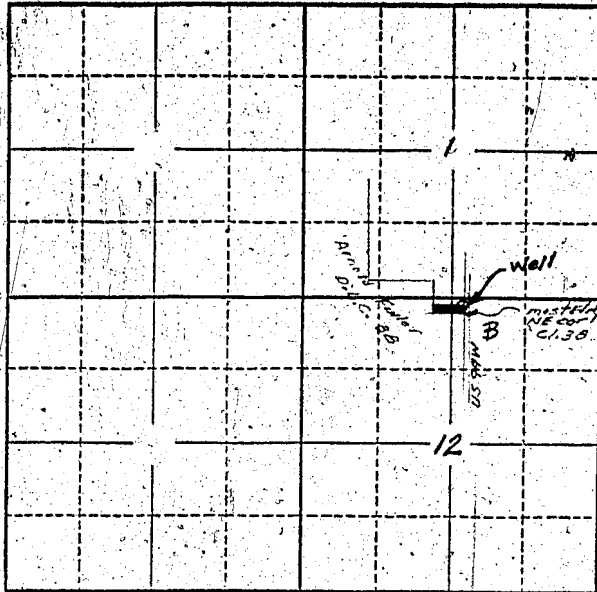

Locate well and acreage of irrigated land on plat.
Scale: 2" = 1 Mile

STATE OF OREGON

County of Benton } ss.

I, Harold James Jensen, being first duly sworn, do hereby certify that I have read the foregoing Registration Statement and that all of the items therein contained are true to the best of my knowledge and belief.

x Harold J. Jensen
(Signature of Registrant)

Subscribed and sworn to before me this 30 day of July, 1958

NOTARY PUBLIC FOR OREGON

My commission expires My Commission Expires Aug. 21, 1960 Edna M. Jensen
(Notary Public)

(SEAL)

CERTIFICATE OF REGISTRATION

STATE OF OREGON

County of Marion } ss.

This is to certify that the foregoing Registration Statement was received in the office of the State Engineer on the 1st day of August, 1958, at 8:30 o'clock A. M. and has been duly recorded in said office in Book No. 16 of Registration Statements on page GR 3773

Witness my hand this 20th day of October, 1959

Laura A. Stanley
(State Engineer)

By _____ (Deputy)

\$15.00

GR 3773