

North

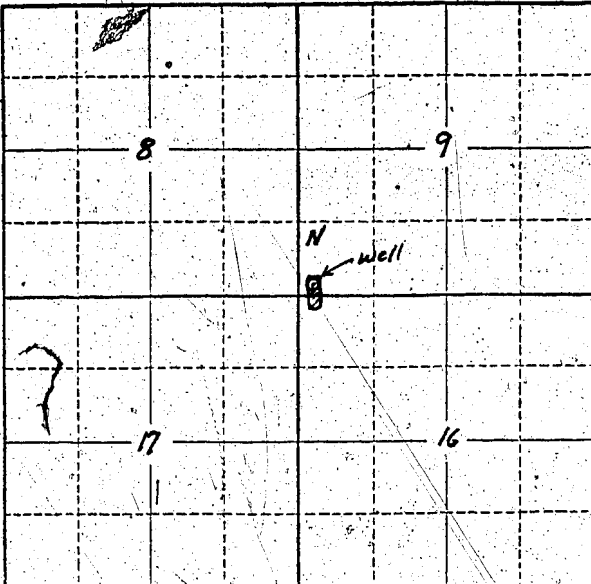

Locate well and acreage of irrigated land on plat.

Scale: 2" = 1 Mile

STATE OF OREGON

County of Multnomah

} ss.

I, H. Niklas, being first duly sworn, do hereby certify that I have read the foregoing Registration Statement and that all of the items therein contained are true to the best of my knowledge and belief.

H. Niklas
(Signature of Registrant)

President, Clackamas Greenhouses, Inc.

Subscribed and sworn to before me this 8th day of December, 1961

My commission expires March 13, 1961

Henry T. Bane
(Notary Public for Oregon)

(SEAL)

CERTIFICATE OF REGISTRATION

STATE OF OREGON

County of Marion

} ss.

This is to certify that the foregoing Registration Statement was received in the office of the State Engineer on the 20th day of December, 1961, at 8:00 o'clock A.M. and has been duly recorded in said office in Book No. 17 of Registration Statements on page GR-4122

Witness my hand this 5th day of January, 1962

Lewis A. Stanley
(State Engineer)

By _____ (Deputy)

\$15.00

GR 4122