

Township 18 S Range 2 W, W.M.

North

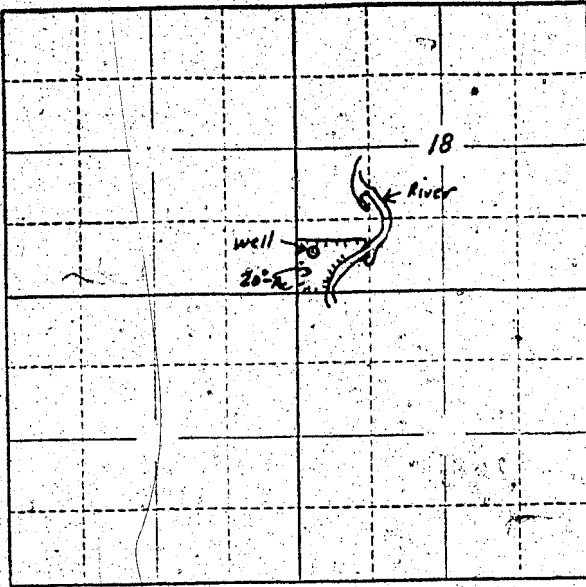

Locate well and acreage of irrigated land on plat.

Scale: 2" = 1 Mile

STATE OF OREGON

County of Lane

ss.

I, Lawrence Bailey, being first duly sworn, do hereby certify that I have read the foregoing Registration Statement and that all of the items therein contained are true to the best of my knowledge and belief.

Lawrence Bailey
(Signature of Registrant)

Subscribed and sworn to before me this 16th day of July, 1962

My commission expires Nov 22 1962

[Signature]
(Notary Public)

(SEAL)

CERTIFICATE OF REGISTRATION

STATE OF OREGON

County of Marion

ss.

This is to certify that the foregoing Registration Statement was received in the office of the State Engineer on the 18th day of July, 1962, at 8:00 o'clock A. M. and has been duly recorded in said office in Book No. 17 of Registration Statements on page GR-7821.

Witness my hand this 20th day of July, 1962

[Signature]
(State Engineer)

By

(Deputy)

\$15.00