

Township 4 S Range 2 W W.M.
North

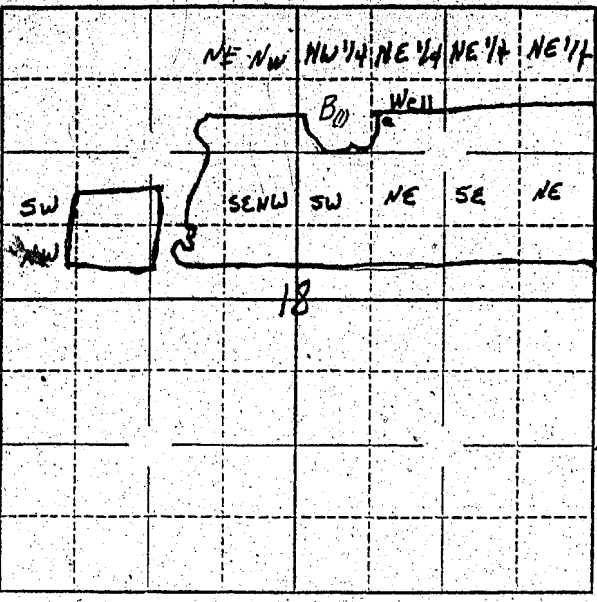

Locate well and acreage of irrigated land on plat.
Scale: $\frac{2''}{4}$ = 1 Mile

STATE OF OREGON

County of Marion } ss.

I, Edgar J. Muller, being first duly sworn, do hereby certify that I have read the foregoing Registration Statement and that all of the items therein contained are true to the best of my knowledge and belief.

Edgar J. Muller
(Signature of Registrant)

Subscribed and sworn to before me this 12th day of April, 1957.

My commission expires ~~My Commission Expires April 29, 1960~~ April 29, 1960

Richard E. Smith
(Notary Public)

(SEAL)

CERTIFICATE OF REGISTRATION

STATE OF OREGON

County of Marion } ss.

This is to certify that the foregoing Registration Statement was received in the office of the State Engineer on the 12th day of April, 1957, at 8:00 o'clock A. M. and has been duly recorded in said office in Book No. 3 of Registration Statements on page GR-426 C.

~~Construction shall be completed by x-x-x-x-x-x-x-x-18-x-x and the water completely applied to be of use by x-x-x-x-x-x-x-x-19-x-x~~

Witness my hand this 26th day of June, 1957

Lewis A. Stanley
(State Engineer)

By _____
(Deputy)

26-25