

North

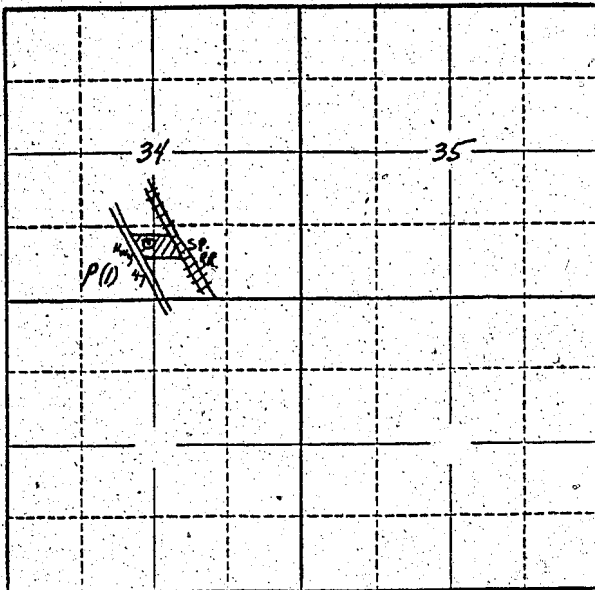

Locate well and acreage of irrigated land on plat.

Scale: 2" = 1 Mile

STATE OF OREGON

County of Yamhill } ss.

I, Ronald O. Wedman, being first duly sworn, do hereby certify that I have read the foregoing Registration Statement and that all of the items therein contained are true to the best of my knowledge and belief.

Ronald O. Wedman
(Signature of Registrant)

Subscribed and sworn to before me this 8 day of July, 1957

My commission expires NOTARY PUBLIC FOR OREGON
My Commission Expires June 12, 1960

Paul Santa
(Notary Public)

(SEAL)

CERTIFICATE OF REGISTRATION

STATE OF OREGON }
County of Marion } ss.

This is to certify that the foregoing Registration Statement was received in the office of the State Engineer on the 24th day of April, 1957, at 8:00 o'clock A. M. and has been duly recorded in said office in Book No. 3 of Registration Statements on page GR-442 C.

Witness my hand this 13th day of September, 1957

Lewis A. Stanley
(State Engineer)

By _____
(Deputy)

15.00