

North

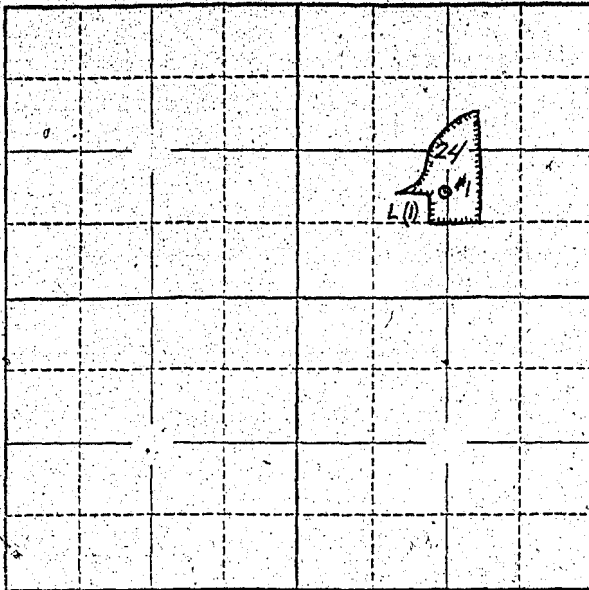

Locate well and acreage of irrigated land on plat.

Scale: 2" = 1 Mile

STATE OF OREGON

County of _____ } ss.

I, _____, being first duly sworn, do hereby certify that I have read the foregoing Registration Statement and that all of the items therein contained are true to the best of my knowledge and belief.

(Signature of Registrant)

Subscribed and sworn to before me this _____ day of _____, 19____

My commission expires _____
(Notary Public)

(SEAL)

See Page GR-474 K for
CERTIFICATE OF REGISTRATION

STATE OF OREGON

County of Marion } ss.

~~This is to certify that the foregoing Registration Statement was received in the office of the State Engineer on the _____ day of _____, 19____ and has been duly recorded in said office in Book _____ of Registration Statements on page _____~~

~~Construction shall be completed by _____, 19____ and the water completely applied to beneficial use by _____, 19____~~

Witness my hand this _____ day of _____, 19____

(State Engineer)

By _____
(Deputy)

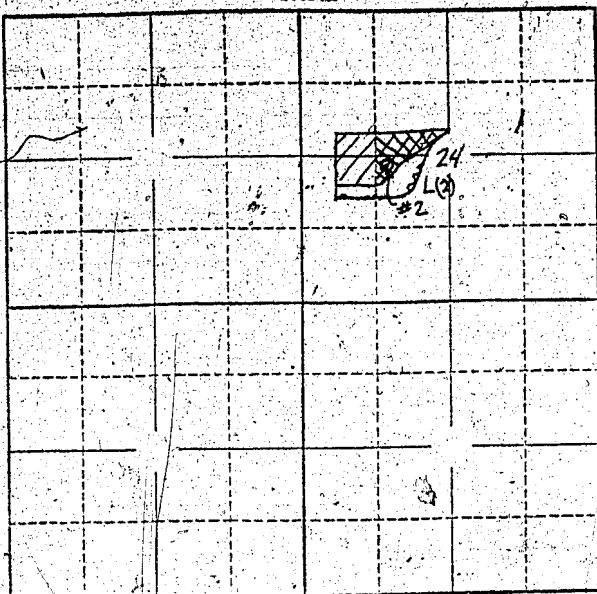

Locate well and acreage of irrigated land on plat.
Scale: 2" = 1 Mile

STATE OF OREGON

County of _____

} ss.

I, _____, being first duly sworn, do hereby certify that I have read the foregoing Registration Statement and that all of the items therein contained are true to the best of my knowledge and belief.

(Signature of Registrant)

Subscribed and sworn to before me this _____ day of _____, 19____

My commission expires _____

(Notary Public)

(SEAL)

See Page GR-474 K for
CERTIFICATE OF REGISTRATION

STATE OF OREGON

County of Marion

} ss.

~~This is to certify that the foregoing Registration Statement was received in the office of the State Engineer on the _____ day of _____, 19____, at _____ and has been duly recorded in said office in Book No. _____ of Registration Statements on page _____~~

~~Construction shall be completed by _____ and the water complete applied to beneficial use by _____~~

Witness my hand this _____ day of _____, 19____

(State Engineer)

By _____

(Deputy)

Township 9S Range 4W W.M.
North

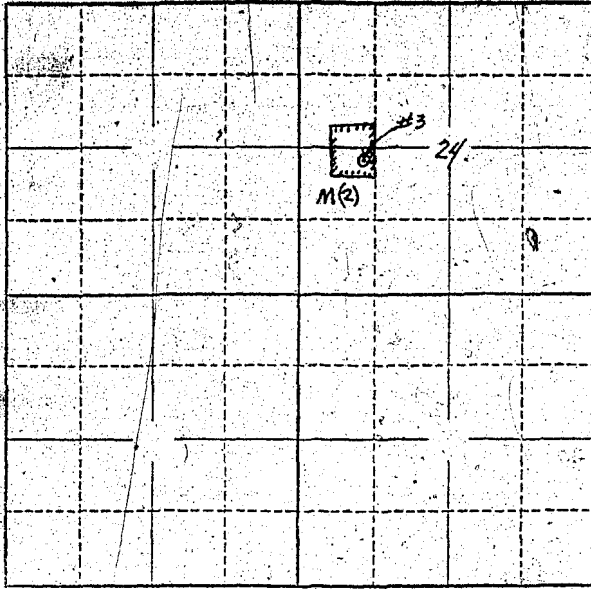

Locate well and acreage of irrigated land on plat.
Scale: 2" = 1 Mile

STATE OF OREGON

County of Marion } ss

I, Jake W. Gilmore, being first duly sworn, do hereby certify that I have read the foregoing Registration Statement and that all of the items therein contained are true to the best of my knowledge and belief.

Jake W. Gilmore
(Signature of Registrant)

Subscribed and sworn to before me this 20 day of May, 1957

My commission expires 9/27/58

Jeanie Baxter
(Notary Public)

(SEAL)

CERTIFICATE OF REGISTRATION

STATE OF OREGON }
County of Marion } ss.

This is to certify that the foregoing Registration Statement was received in the office of the State Engineer on the 20th day of May, 1957, at 9:00 o'clock A. M. and has been duly recorded in said office in Book No. 3 of Registration Statements on page GR-474 K

~~Construction shall be completed by x-x-x-x-x-x-x-x-x-x-19-x-x and the water completely applied to beneficial use by x-x-x-x-x-x-x-x-x-x-19-x-x-x-x~~

Witness my hand this 26th day of June, 1957

Lewis A. Stanley
(State Engineer)

24-45

By _____ (Deputy) GR - 474 K