

North

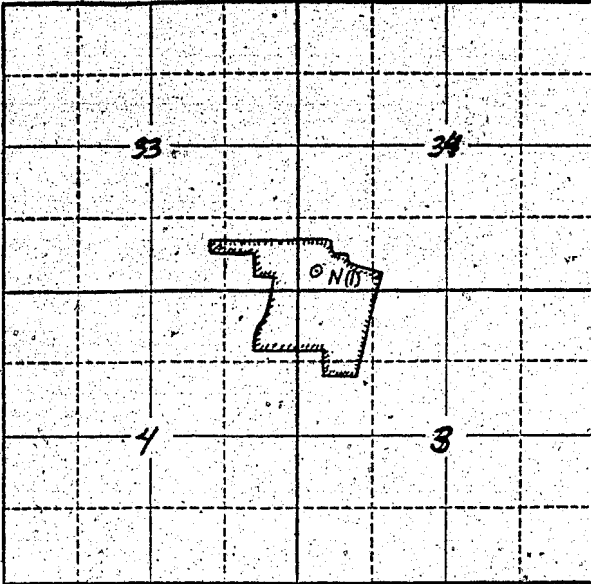

Locate well and acreage of irrigated land on plat.

Scale: 2" = 1 Mile

STATE OF OREGON

County of Linn } ss.

I, John & Letha Glaser, being first duly sworn, do hereby certify that I have read the foregoing Registration Statement and that all of the items therein contained are true to the best of my knowledge and belief.

*John & Letha Glaser*  
*John Glaser*  
 (Signature of Registrant)

Subscribed and sworn to before me this 18<sup>th</sup> day of May, 1957

My commission expires \_\_\_\_\_ MY COMMISSION EXPIRES JUNE 18, 1959

*M. J. [unclear]*  
 (Notary Public)

(SEAL)

**CERTIFICATE OF REGISTRATION**

STATE OF OREGON }  
County of Marion } ss.

This is to certify that the foregoing Registration Statement was received in the office of the State Engineer on the 22nd day of May, 1957 at 8:00 o'clock A. M. and has been duly recorded in said office in Book No. 3 of Registration Statements on page GR-478 C

Witness my hand this 26th day of June, 1957

*Leuro A. Stanley*  
 (State Engineer)

By \_\_\_\_\_ (Deputy)

# 25-55

GR - 478 C