

Township 17S Range 4W WEST 1/4 W. 11.4 METERS MERIDIAN W.M.

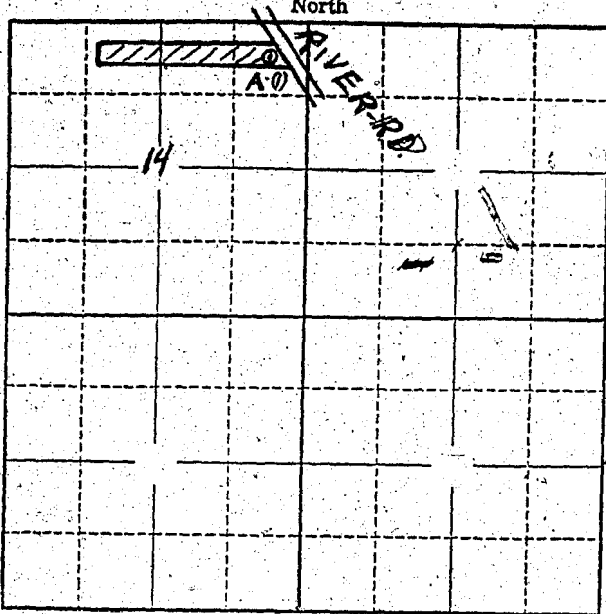

Place in Section 1
Well at spot 150 FT
west from River Road &
65' from So. line

Locate well and acreage of irrigated land on plat.

Scale: 1" = 1 Mile
4" = 1 Mile

STATE OF OREGON

County of Linn } ss.

I, William B. Terpening, being first duly sworn, do hereby certify that I have read the foregoing Registration Statement and that all of the items therein contained are true to the best of my knowledge and belief.

William B. Terpening
(Signature of Registrant)

Subscribed and sworn to before me this 31st day of May, 1957

My commission expires April 11, 1960
John S. Smith
(Notary Public)

(SEAL)

CERTIFICATE OF REGISTRATION

STATE OF OREGON }
County of Marion } ss.

This is to certify that the foregoing Registration Statement was received in the office of the State Engineer on the 7th day of June, 1957, at 8:00 o'clock A. M. and has been duly recorded in said office in Book No. 3 of Registration Statements on page GR-487 C.

Witness my hand this 24th day of July, 1957
Lewis A. Stanley
(State Engineer)

\$15.00

By _____
(Deputy)