

North

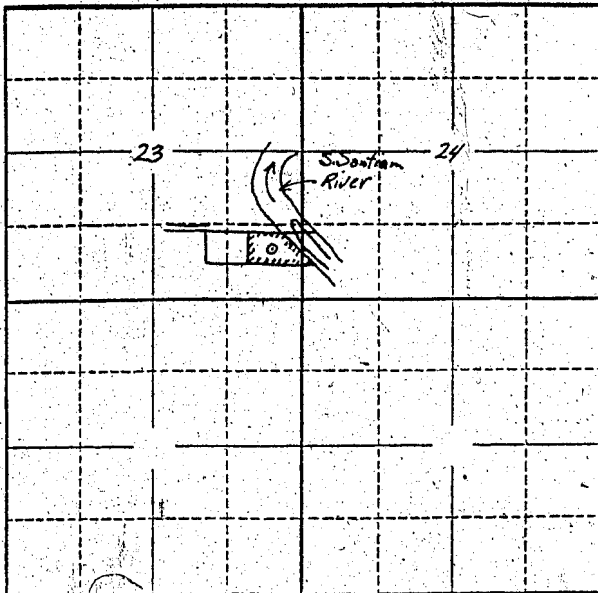

Locate well and acreage of irrigated land on plat.

Scale: 2" = 1 Mile

STATE OF OREGON

County of Linn } ss.

I, Hiram A. and Sadie Gregson, being first duly sworn, do hereby certify that I have read the foregoing Registration Statement and that all of the items therein contained are true to the best of my knowledge and belief.

Hiram A. Gregson
Sadie Gregson
(Signature of Registrant)

Subscribed and sworn to before me this 6th day of June, 1957.

My commission expires July 13, 1958

Alta Nelson
(Notary Public)

(SEAL)

CERTIFICATE OF REGISTRATION

STATE OF OREGON } ss.
County of Marion

This is to certify that the foregoing Registration Statement was received in the office of the State Engineer on the 27th day of June, 1957, at 8:00 o'clock A.M. and has been duly recorded in said office in Book No. 3 of Registration Statements on page GR-509 C.

Witness my hand this 24th day of July, 1957.

Lewis A. Stanley
(State Engineer)

By (Deputy)

7.15.00