

Township 65 Range 2W, W.M.
North

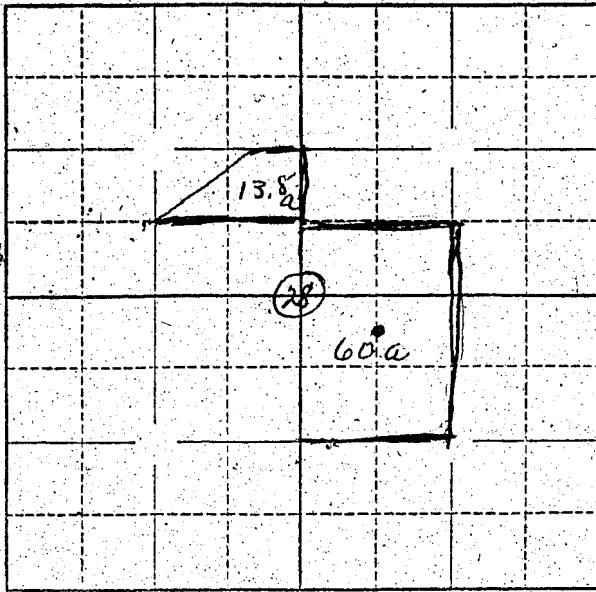

Locate well and acreage of irrigated land on plat.

Scale: 3" = 1 Mile

STATE OF OREGON

County of Marion

ss.

I, Glen M. Looney, being first duly sworn, do hereby certify that I have read the foregoing Registration Statement and that all of the items therein contained are true to the best of my knowledge and belief.

Glen M. Looney
(Signature of Registrant)

Subscribed and sworn to before me this 6th day of December, 1955.

My commission expires 7/27/58

Jeanie Baxter
(Notary Public)

(SEAL)

CERTIFICATE OF REGISTRATION

STATE OF OREGON

County of Marion

ss.

This is to certify that the foregoing Registration Statement was received in the office of the State Engineer on the 6th day of December, 1955, at 8:00 o'clock P. M. and has been duly recorded in said office in Book No. 1 of Registration Statements on page 47.

Construction shall be completed by 15 1955, and the water is completely applied to beneficial use by 10 1955.

Witness my hand this 24th day of February, 1956.

Lewis A. Glavin
(State Engineer)

By _____

(Deputy)