

Township 145 Range 5W SW, W.M.
 North

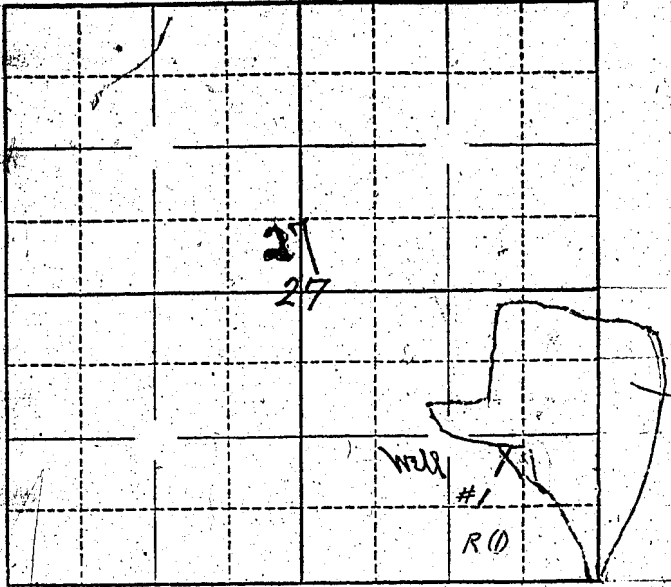

Locate well and acreage of irrigated land on plat.
 Scale: 2" = 1 Mile

STATE OF OREGON }
 County of Benton } ss.

I, C. M. Hubbard & Son, being first duly sworn, do hereby certify that I have read the foregoing Registration Statement and that all of the items therein contained are true to the best of my knowledge and belief.

by: C. M. Hubbard & Son
 (Signature of Registrant)

Subscribed and sworn to before me this 12 day of July, 19 57

My commission expires July 25, 1958

E. Ruby
 (Notary Public)

(SEAL)

CERTIFICATE OF REGISTRATION

STATE OF OREGON }
 County of Marion } ss.

This is to certify that the foregoing Registration Statement was received in the office of the State Engineer on the 23rd day of July, 19 57, at 6 o'clock A.M. and has been duly recorded in said office in Book No. 4 of Registration Statements on page GR-570 C.

Witness my hand this 16th day of October, 19 57

Lewis A. Stanley
 (State Engineer)

#1950

By _____ (Deputy)