

Township 18 Range 3E, W.M.
North

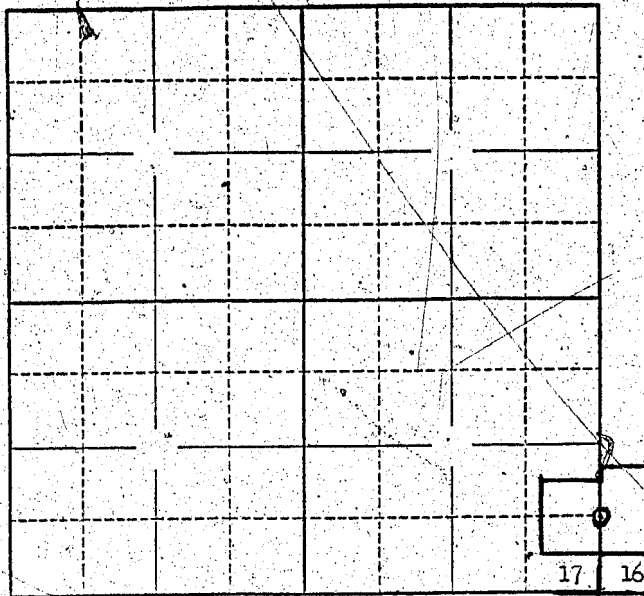

Location of well.

Locate well and acreage of irrigated land on plat. 20 21

Scale: 2" = 1 Mile

STATE OF OREGON

County of Washington } ss.

I, J. Paul Reynolds, being first duly sworn, do hereby certify that I have read the foregoing Registration Statement and that all of the items therein contained are true to the best of my knowledge and belief.

J. Paul Reynolds
(Signature of Registrant)

Subscribed and sworn to before me this 4 day of September, 1955

My commission expires February 26, 1956
W. P. Jones
(Notary Public)

(SEAL)

CERTIFICATE OF REGISTRATION

STATE OF OREGON } ss.
County of Marion

This is to certify that the foregoing Registration Statement was received in the office of the State Engineer on the 2nd day of September, 1955, at 8:00 o'clock A. M. and has been duly recorded in said office in Book No. 1 of Registration Statements on page 5

Construction shall be completed by 1955, and the water completely applied to beneficial use by 1955

Witness my hand this 24th day of February, 1956.

Lewis A. Stanley
(State Engineer)

By _____
(Deputy)