

From along 1/4 of west section 17
 50.733a

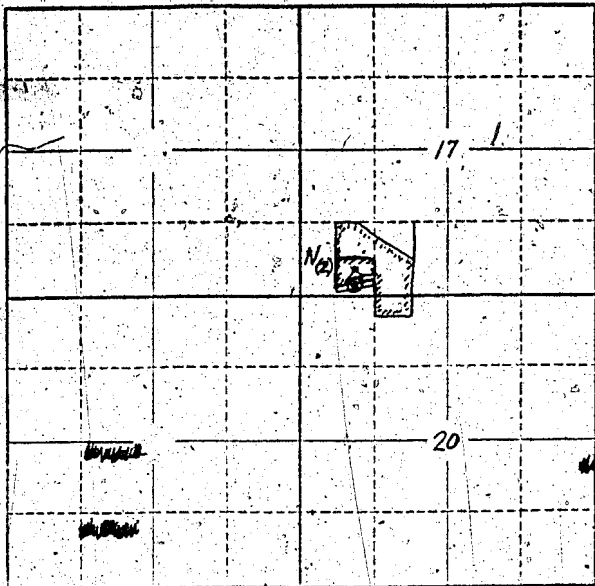

Locate well and acreage of irrigated land on plat.
Scale: 2" = 1 Mile

STATE OF OREGON

County of Lane } ss.

I, Cyril Schindler, being first duly sworn, do hereby certify that I have read the foregoing Registration Statement and that all of the items therein contained are true to the best of my knowledge and belief.

Cyril Schindler
(Signature of Registrant)

Subscribed and sworn to before me this 6th day of September, 1957.

My commission expires April 11, 1960

Edwin Stuebner
(Notary Public)

(SEAL)

CERTIFICATE OF REGISTRATION

STATE OF OREGON } ss.
County of Marion

This is to certify that the foregoing Registration Statement was received in the office of the State Engineer on the 11 day of September, 1957, at 8:00 o'clock A. M. and has been duly recorded in said office in Book No. 4 of Registration Statements on page GR 764-C

~~Construction shall be completed by October 19, 1957 and the water shall be conveyed to the beneficial use by October 19, 1957~~

Witness my hand this 4th day of February, 1957

Lewis A. Stanley
(State Engineer)

By _____ (Deputy)