

Township 6 S Range 3 W W.M.
North

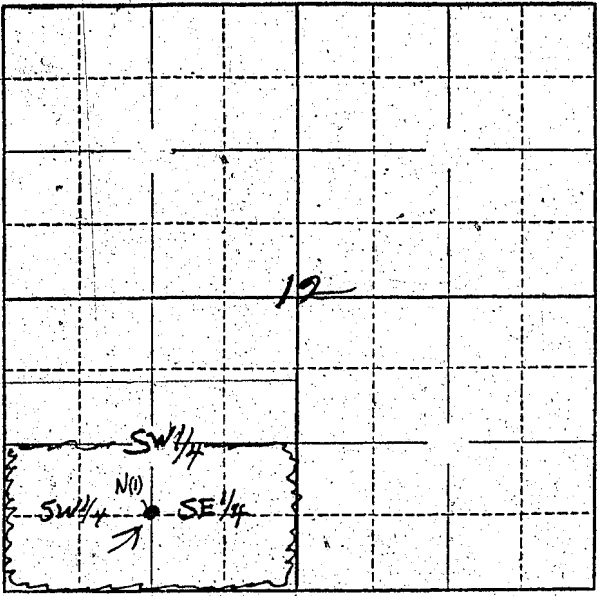

Locate well and acreage of irrigated land on plat.
Scale: 2" = 1 Mile

STATE OF OREGON

County of Marion } ss.

I, Robert L Reed, being first duly sworn, do hereby certify that I have read the foregoing Registration Statement and that all of the items therein contained are true to the best of my knowledge and belief.

Robert L Reed
(Signature of Registrant)

Subscribed and sworn to before me this 22 day of October, 1957.

My commission expires September 8, 1960

M. D. Rogers
(Notary Public)

(SEAL)

CERTIFICATE OF REGISTRATION

STATE OF OREGON

County of Marion } ss.

This is to certify that the foregoing Registration Statement was received in the office of the State Engineer on the 22nd day of October, 1957, at 8:00 o'clock A. M. and has been duly recorded in said office in Book No. 4 of Registration Statements on page GR-643 C.

Witness my hand this 27th day of November, 1957.

LEWIS A. STANLEY
(State Engineer)

By M. D. Rogers
(Deputy)

22.50