

North

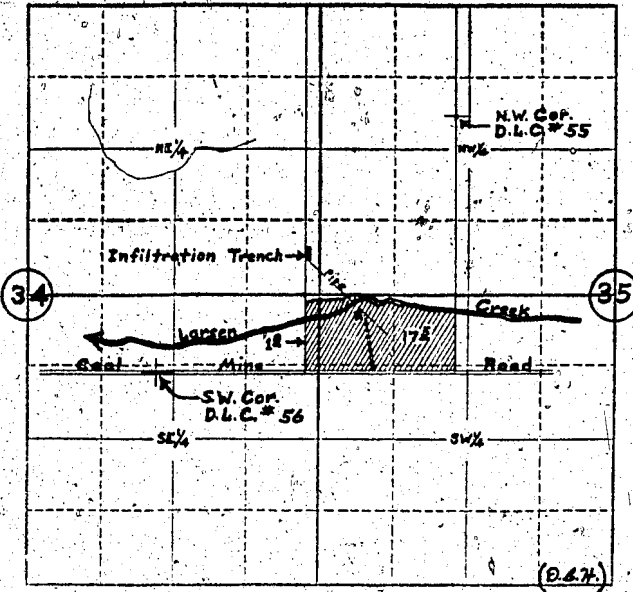

Locate well and acreage of irrigated land on plat.

Scale: 4" = 1 Mile

STATE OF OREGON

County of Jackson

ss.

I, S. E. Hansen, being first duly sworn, do hereby certify that I have read the foregoing Registration Statement and that all of the items therein contained are true to the best of my knowledge and belief.

S. E. Hansen (Signature of Registrant)

Subscribed and sworn to before me this 19th day of November, 1957

My commission expires Nov. 23-1960

Jaydak (Notary Public)

(SEAL)

CERTIFICATE OF REGISTRATION

STATE OF OREGON

County of Marion

ss.

This is to certify that the foregoing Registration Statement was received in the office of the State Engineer on the 20th day of November, 1957, at 1:00 o'clock P.M. and has been duly recorded in said office in Book No. 4 of Registration Statements on page GR-701 C.

Construction shall be completed by 12-31-1958 and the water completely applied to beneficial use by 1-1-1959

Witness my hand this 21st day of January, 1958

Lewis A. Stanley (State Engineer)

By

(Deputy)

GR-701 C