

North

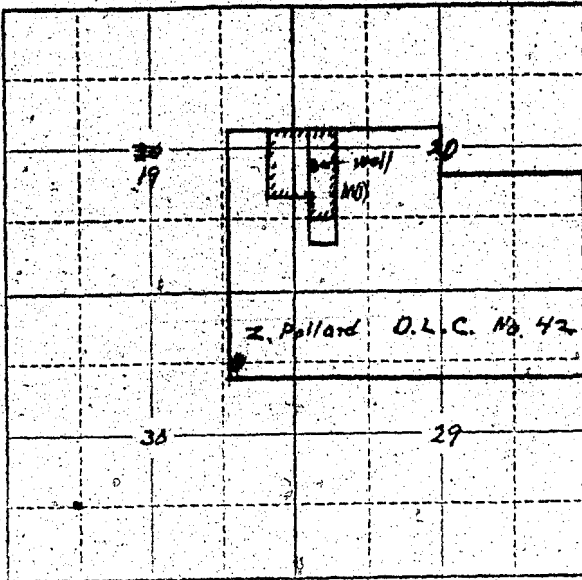

Locate well and acreage of irrigated land on plat.

Scale: 2" = 1 Mile

STATE OF OREGON

County of Marion

ss.

I, _____, being first duly sworn, do hereby certify that I have read the foregoing Registration Statement and that all of the items therein contained are true to the best of my knowledge and belief.

Arthur P. Young, Myra B. Young
(Signature of Registrant)

Subscribed and sworn to before me this 3rd day of December 1957

My commission expires June 12th 1961 Wm. S. Bartholomew
(Notary Public)

(SEAL)

CERTIFICATE OF REGISTRATION

STATE OF OREGON }
County of Marion } ss.

This is to certify that the foregoing Registration Statement was received in the office of the State Engineer on the 3rd day of December, 1957, at 6:00 o'clock A.M. and has been duly recorded in said office in Book No. 4 of Registration Statements on page 33-728 C

Construction shall be completed by 19-58 and the water completely applied to beneficial use by 19-58

Witness my hand this 21st day of January 1958

Laura A. Otterley
(State Engineer)

By _____ (Deputy)