

North

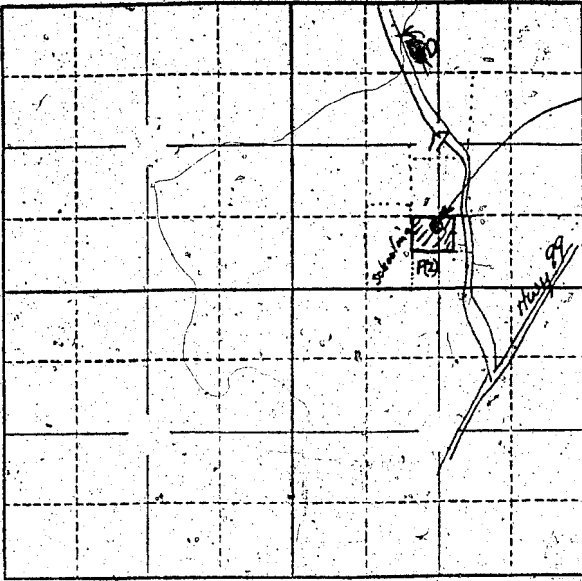

Locate well and acreage of irrigated land on plat.

Scale: 2" = 1 Mile

STATE OF OREGON

County of Lane

ss.

I, L. J. Bryson, being first duly sworn, do hereby certify that I have read the foregoing Registration Statement and that all of the items therein contained are true to the best of my knowledge and belief.

(Signature of Registrant)

Subscribed and sworn to before me this 27th day of December, 1957

My commission expires Dec. 15, 1961

(Notary Public)

(SEAL)

CERTIFICATE OF REGISTRATION

STATE OF OREGON

County of Marion

ss.

This is to certify that the foregoing Registration Statement was received in the office of the State Engineer on the 30th day of December, 1957, at 6:00 o'clock A. M. and has been duly recorded in said office in Book No. 6 of Registration Statements on page GR-1109

Witness my hand this 20 day of August, 1958

(State Engineer)

By

(Deputy)