

Township 15S Range 4W, W.M.
North

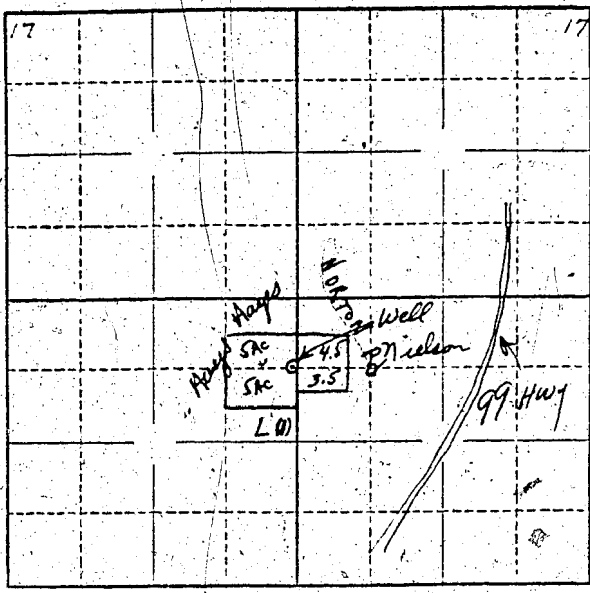

Locate well and acreage of irrigated land on plat.
Scale: $\frac{1}{4}$ " = 1 Mile

STATE OF OREGON
County of Lane

461
} ss.

I, L. J. Bryson, being first duly sworn, do hereby certify that I have read the foregoing Registration Statement and that all of the items therein contained are true to the best of my knowledge and belief.

(Signature of Registrant)

Subscribed and sworn to before me this 27th day of December, 1957.

My commission expires Dec. 15, 1961

[Signature]
(Notary Public)

(SEAL)

CERTIFICATE OF REGISTRATION

STATE OF OREGON }
County of Marion } ss.

This is to certify that the foregoing Registration Statement was received in the office of the State Engineer on the 26th day of December, 1957, at o'clock M. and has been duly recorded in said office in Book No. 6 of Registration Statements on page GR-1110

Witness my hand this 20 day of August, 1958

[Signature]
(State Engineer)

By
(Deputy)