

North

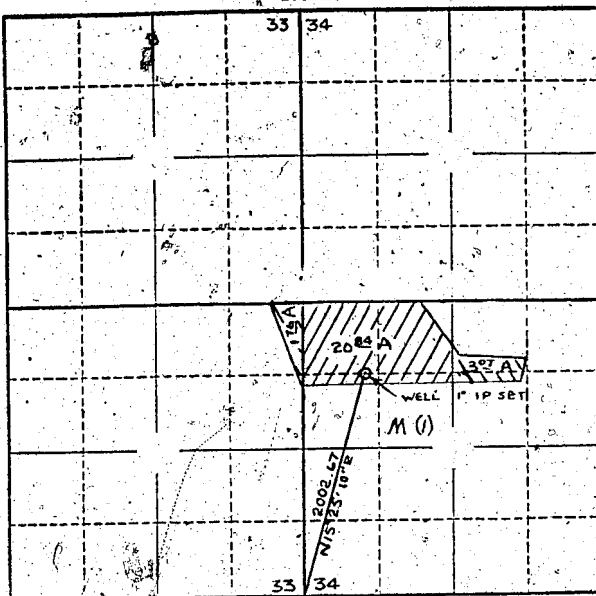

Locate well and acreage of irrigated land on plat.

Scale: 4" = 1 Mile

STATE OF OREGON

County of Marion Co

SS.

I, \_\_\_\_\_, being first duly sworn, do hereby certify that I have read the foregoing Registration Statement and that all of the items therein contained are true to the best of my knowledge and belief.

*B. ...*  
(Signature of Registrant)

Subscribed and sworn to before me this 20th day of January, 1958.

My commission expires 12th June 1961. *Wm. S. Bartholomew*  
(Notary Public)

(SEAL)

CERTIFICATE OF REGISTRATION

STATE OF OREGON

County of Marion

SS.

This is to certify that the foregoing Registration Statement was received in the office of the State Engineer on the 20 day of January, 1958, at 10:00 o'clock A.M. and has been duly recorded in said office in Book No. 5 of Registration Statements on page 884.

Witness my hand this 24 day of April, 1958.

*Lewis A. Stanley*  
(State Engineer)

By \_\_\_\_\_  
(Deputy)