

RECEIVED

FEB 09 1990

WATER RESOURCES DEPT.
SALEM, OREGON

T.28S. R.4W. W.M.

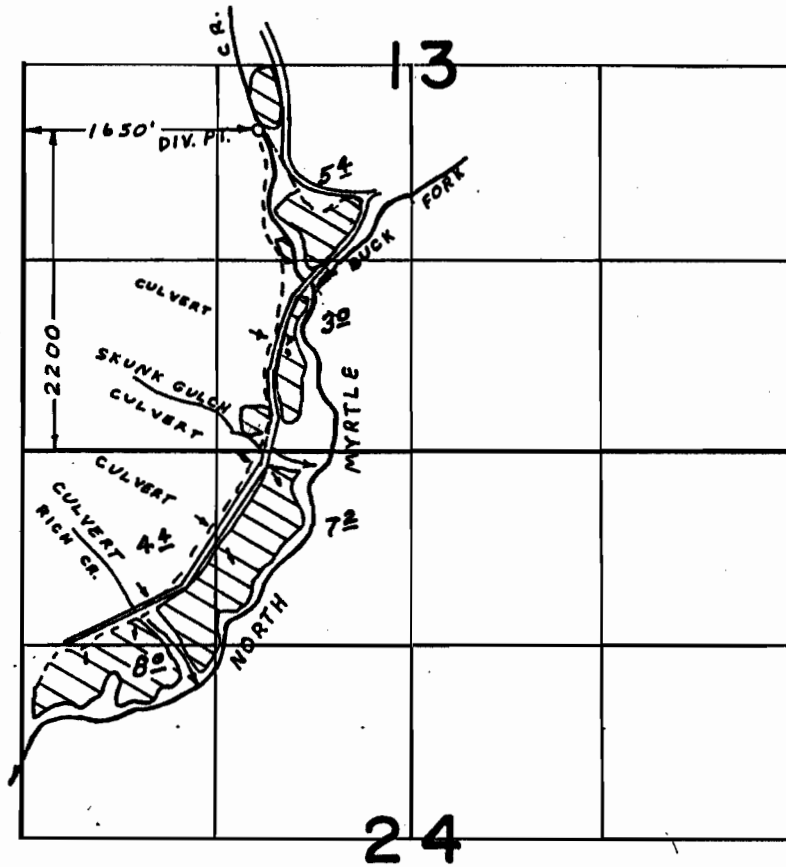

FINAL PROOF SURVEY
UNDER

Application No. 46796 Permit No. 34988
IN NAME OF

FLOYD F. GIESE

Surveyed MAR 26 1975, by LH NUNN

T28S R4W WM

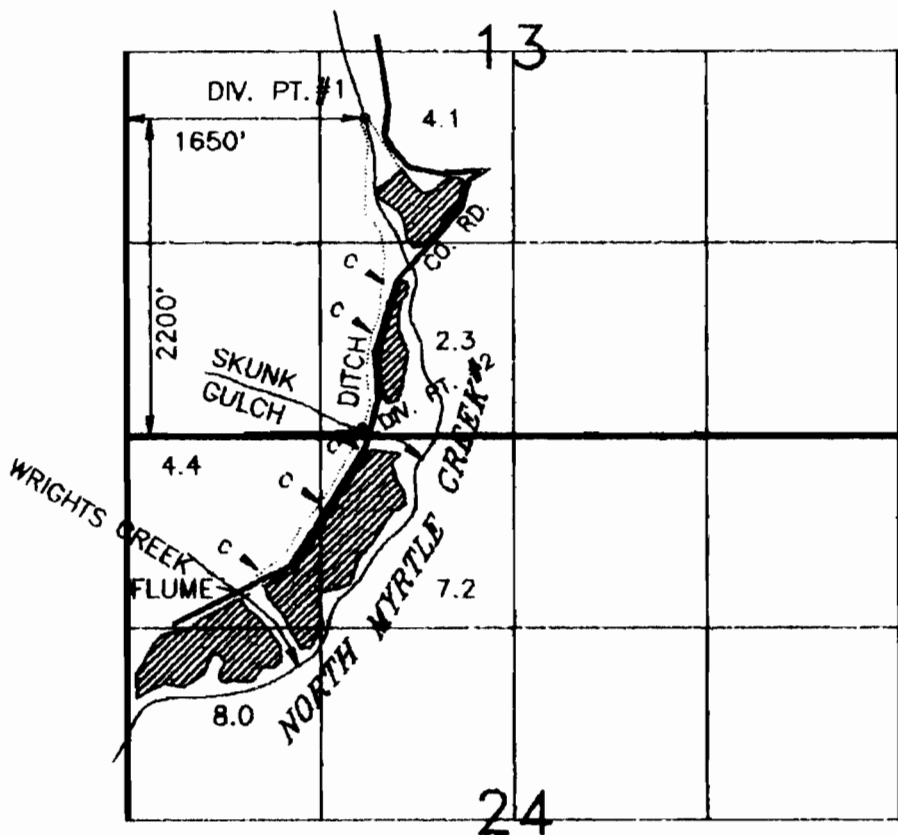

DIVERSION POINT #2 IS
1600 FEET EAST AND
30 FEET NORTH FROM THE
SOUTHWEST CORNER OF
SECTION 13



SCALE 1" = 1320'

NOTE: ALL LAND IN SECTION 24 IS ALSO IRRIGATED FROM SKUNK GULCH

SURVEY IS REDRAWN FROM FINAL PROOF SURVEY FOR PERMIT 34988
SURVEYED MARCH 26 1975

 CULVERTS UNDER ROAD USED FOR IRRIGATION

SURVEY OF CLAIM FOR VESTED WATER RIGHT IN NAME OF

Floyd F. Giese

DATE JULY 16, 1989

BY: WILLIAM J. RUPPERT
P.O. BOX 1564
MYRTLE CREEK, OR 97457

SWR-11