

RECEIVED

DEC 14 1992

WATER RESOURCES DEPT.
SALEM, OREGON

SECTION 16, T29S, R3W, WM

MAP BASED ON
FINAL PROOF
SURVEY OF
PERMIT No.
31775
11 JUNE 1970

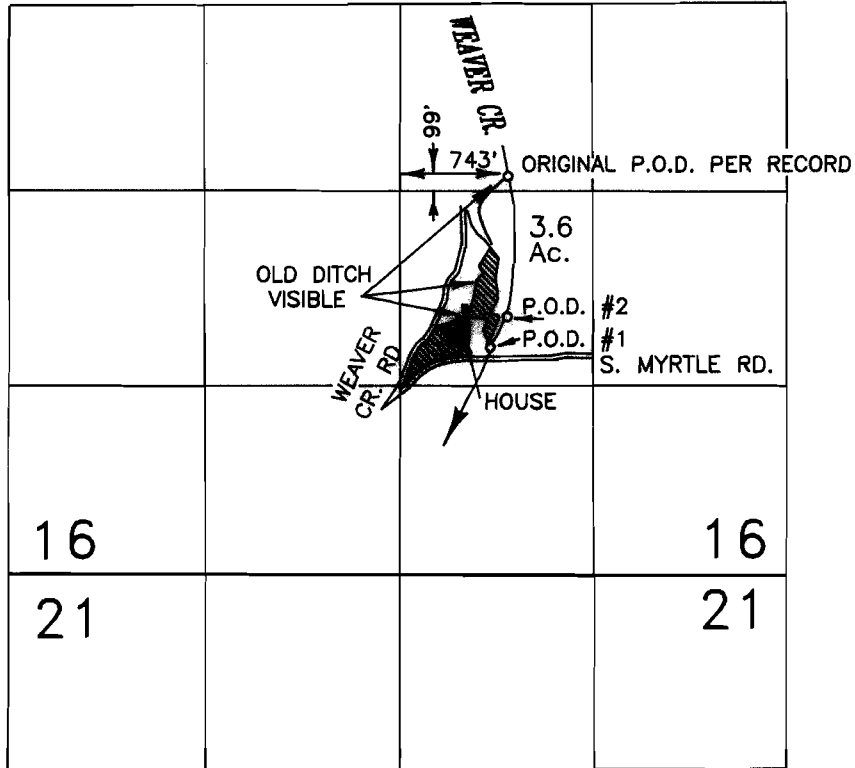

SEE ALSO
ATTACHED
SITE REPORT

FROM RECORD, P.O.D. #1 IS 260' NORTH AND 620' EAST FROM CS 1/16 CORNER SECTION 16
FROM RECORD, P.O.D. #2 IS 480' NORTH AND 740' EAST FROM CS 1/16 CORNER SECTION 16

THIS MAP IS TO BE USED FOR WATER RIGHT PURPOSES ONLY

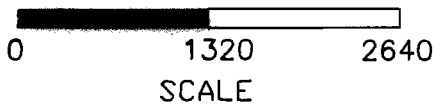

MAP TO ACCOMPANY CLAIM FOR VESTED WATER RIGHT IN NAME OF

Perry Murray

DATE NOVEMBER 11, 1992

BY: WILLIAM J. RUPPERT
P.O. BOX 1564
MYRTLE CREEK, OR 97457

