

VESTED WATER RIGHTS APPLICATION MAP
LOCATED IN

TOWNSHIP 31 SOUTH, RANGE 12 AND 13 WEST W.M.
CURRY COUNTY, OR.

MAP PREPARED FOR: SAM DEMENT
DATE OF FIELD SURVEY: SEPT. 11, 1992

SHEET 1 OF 2

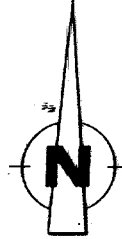

SCALE 1"=2640'

RANGE 14 WEST
RANGE 13 WEST

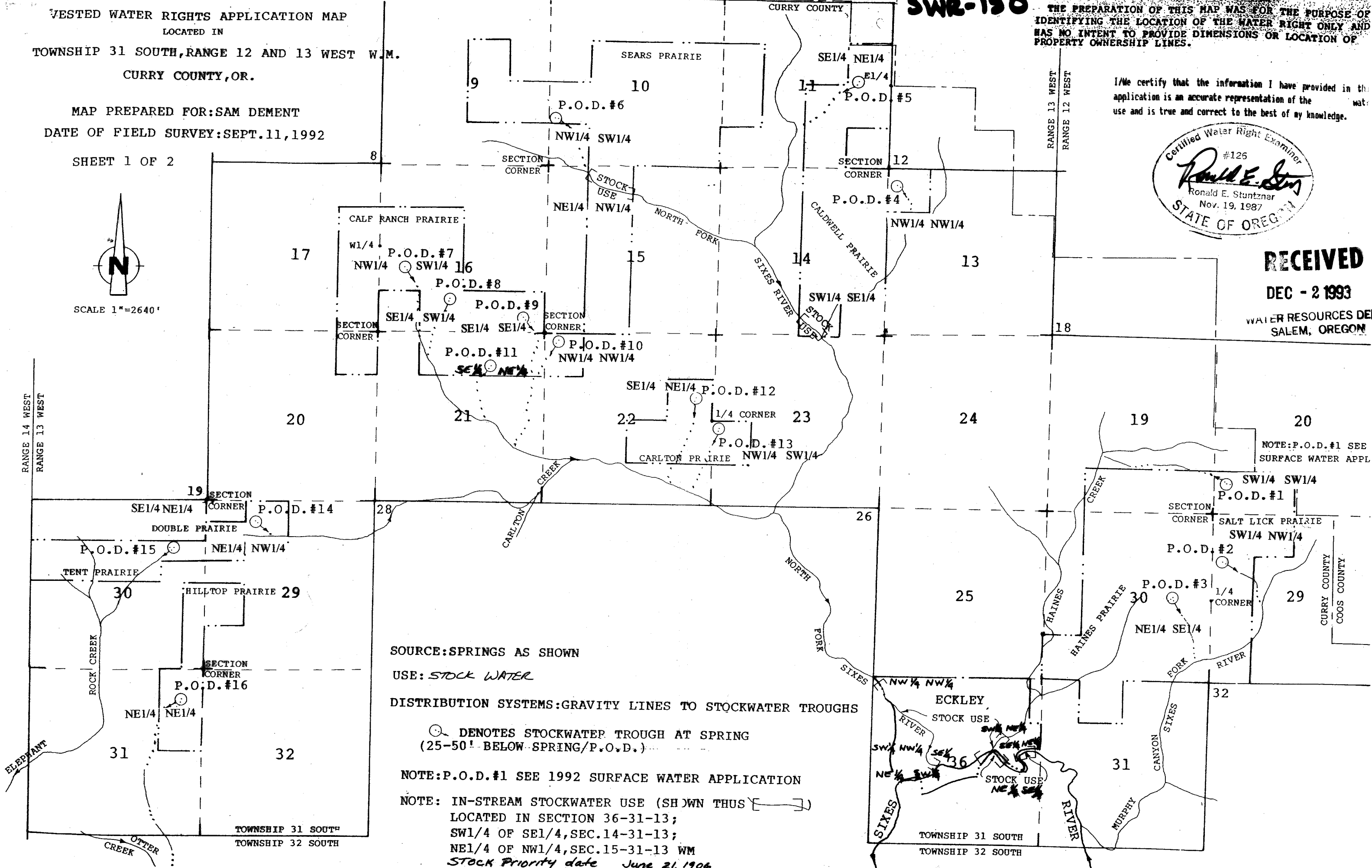

SWR-150

THE PREPARATION OF THIS MAP WAS FOR THE PURPOSE OF IDENTIFYING THE LOCATION OF THE WATER RIGHT ONLY AND HAS NO INTENT TO PROVIDE DIMENSIONS OR LOCATION OF PROPERTY OWNERSHIP LINES.

I/We certify that the information I have provided in the application is an accurate representation of the water use and is true and correct to the best of my knowledge.

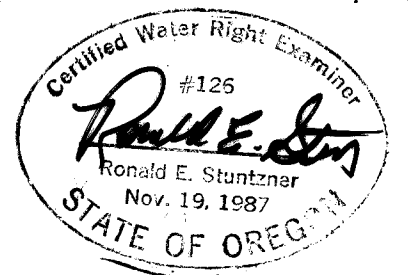

RECEIVED
DEC - 2 1993
WATER RESOURCES DEPT.
SALEM, OREGON

NOTE: P.O.D. #1 SEE SURFACE WATER APPL

SOURCE: SPRINGS AS SHOWN

USE: STOCK WATER

DISTRIBUTION SYSTEMS: GRAVITY LINES TO STOCKWATER TROUGHS

○ DENOTES STOCKWATER TROUGH AT SPRING
(25-50' BELOW SPRING/P.O.D.)

NOTE: P.O.D. #1 SEE 1992 SURFACE WATER APPLICATION

NOTE: IN-STREAM STOCKWATER USE (SHOWN THUS [---])
LOCATED IN SECTION 36-31-13;
SW1/4 OF SE1/4, SEC. 14-31-13;
NE1/4 OF NW1/4, SEC. 15-31-13 WM
STOCK Priority date June 21, 1906

TOWNSHIP 31 SOUTH
TOWNSHIP 32 SOUTH

TOWNSHIP 31 SOUTH
TOWNSHIP 32 SOUTH

DEMENT RANCH

VESTED WATER RIGHTS APPLICATION MAP

SUPPLEMENTAL MAP INFORMATION

SHEET 2 OF 2

DIVERSION LOCATIONS

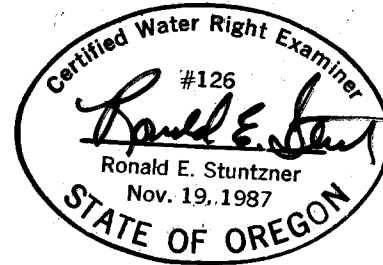

POD #1: See 1992 Surface Water Application

POD #2: Location: 1600' South and 330' East of NW Corner, Sec.29-31-12 in NW1/4, NW1/4, SW1/4, NW1/4, Section 29.
Source: Spring, Flow = 1 Gal./Min.
Distribution System: 1" Plastic Gravity Line to 200 Gallon Powder River Stock Water Tank.

POD #3: Location: 2700' South and 1200' West of NE Corner, Sec.30-31-12 in NW1/4, NW1/4, NE1/4, SE1/4, Section 30.
Source: Spring, Flow = 1/2 Gal./Min.
Distribution System: Gravity to 200 Gallon Powder River Stock Water Tank.

POD #4: Location: 530' South and 330' East of NW Corner, Sec. 13-31-13 in SW1/4, NW1/4, NW1/4, NW1/4, Section 13.
Source: Spring, Flow = 1/10 Gal./Min.
Distribution System: 3/4" Iron Pipe Line Gravity to 200 Gal. Powder River Stock Water Tank.

POD #5: Location: 0' South and 1050' West of the East 1/4 Corner, Sec.11-31-13 in SW1/4, SE1/4, SE1/4, SE1/4, Section 11.
Source: Spring, Flow = 1/4 Gal./Min.
Distribution System: 3/4" Iron Pipe Line Gravity to 200 Gal. Stock Water Tank.

POD #6: Location: 1450' North and 260' East of SW Corner Sec.10-31-13 in SW1/4, SW1/4, NW1/4, SW1/4, Section 10.
Source: Spring, Flow = 1 Gal./Min.
Distribution System: 1-1/2" Plastic Gravity Line to 200 Gallon Powder River Stock Water Tank.

POD #7: Location: 600' South and 800' East of West 1/4 Sec.16-31-13 in SW1/4, NE1/4, NW1/4, SW1/4 Section 16.
Source: Spring, Flow = 1/10 Gal./Min.
Distribution System: Gravity to 200 Gal. Powder River Stock Water Tank.

SWR-150
POD #8: Location: 1050' North and 2250' East of SW Corner Sec.16-31-13 in SW1/4, NE1/4, SE1/4, SW1/4, Section 16.
Source: Spring, Flow = 1/10 Gal./Min.
Distribution System: Gravity to 100 Gal. Steel Stock Water Tank.

POD #9: Location: 530' North and 660' West of SE Corner Sec.16-31-13 in SE1/4, SW1/4, SE1/4, SE1/4 Section 16.
Source: Spring, Flow = 1/2 Gal./Min.
Distribution System: 3/4" Plastic Gravity Line to 100 Gal. Plastic Stock Water Tank.

POD #10: Location: 260' South and 460' East of NW Corner Sec.22-31-13 in NE1/4, NW1/4, NW1/4, NW1/4, Section 22.
Source: Spring, Flow = 1/2 Gal./Min.
Distribution System: 1" Iron Pipe Line Gravity to 150 Gal. Concrete Stock Water Tank.

POD #11: Location: 1050' South and 1650' West of NE Corner Sec.21-31-13 in SW1/4, SE1/4, NW1/4, NE1/4, Section 21.
Source: Spring, Flow 1/10 Gal./Min.
Distribution System: 3/4" Iron Pipe Gravity Line to 50 Gal. Steel Stock Water Tank.

POD #12: Location: 725' North and 525' West of the 1/4 Corner Common to Sec.22 and 23-31-13 in SW1/4, NE1/4, SE1/4, NE1/4, Section 22.
Source: Spring, Flow 1/10 Gal./Min.
Distribution System: 1" Plastic Gravity Line to 150 Gal. Concrete Stock Water Tank.

POD #13: Location: 260' South and 260' East of the 1/4 Corner Common to Sec.22 and 23-31-13 in NW1/4, NW1/4, NW1/4, SW1/4 of Section 23.
Source: Spring, Flow = 1 Gal./Min.
Distribution System: 1" PVC Gravity Line to 75 Gal. Steel Stock Water Tank.

POD #14: Location: 660' South and 1550' East of the NW Corner Sec.29-31-13 in NW1/4, SW1/4, NW1/4, NW1/4, Section 29.
Source: Spring, Flow = 1/10 Gal./Min.
Distribution System: 1" Plastic Gravity Line to 50 Gal. Steel Stock Water Tank.

POD #15: Location: 1520' South and 1050' West of the NE Corner Sec.30-31-13 in NE1/4, NW1/4, SE1/4, NE1/4, Section 30.
Source: Spring, Flow = 1 Gal./Min.
Distribution System: Gravity Line to 500 Gal. Steel Stock Water Tank.

POD #16: Location: 1000' South and 660' West of the NE Corner of Sec.31-31-13 in NW1/4, SE1/4, NE1/4, NE1/4 of Section 31.
Source: Spring, Flow 1/10 Gal./Min.
Distribution System: 1-1/2" PVC Gravity Line to 100 Gal. Metal Stock Water Tank.