

T. 29 S., R. 12 W. W.M. Sec. 16, 15, 22, 21

Map for a pre-1909 Surface Water Registration.

Scale: 1" = 1320ft.

Date of Survey Aug. 1990.

Map 2 of 2

SWR 212

**RECEIVED**

NOV 10 1993

WATER RESOURCES DEPT.  
SALEM, OREGON

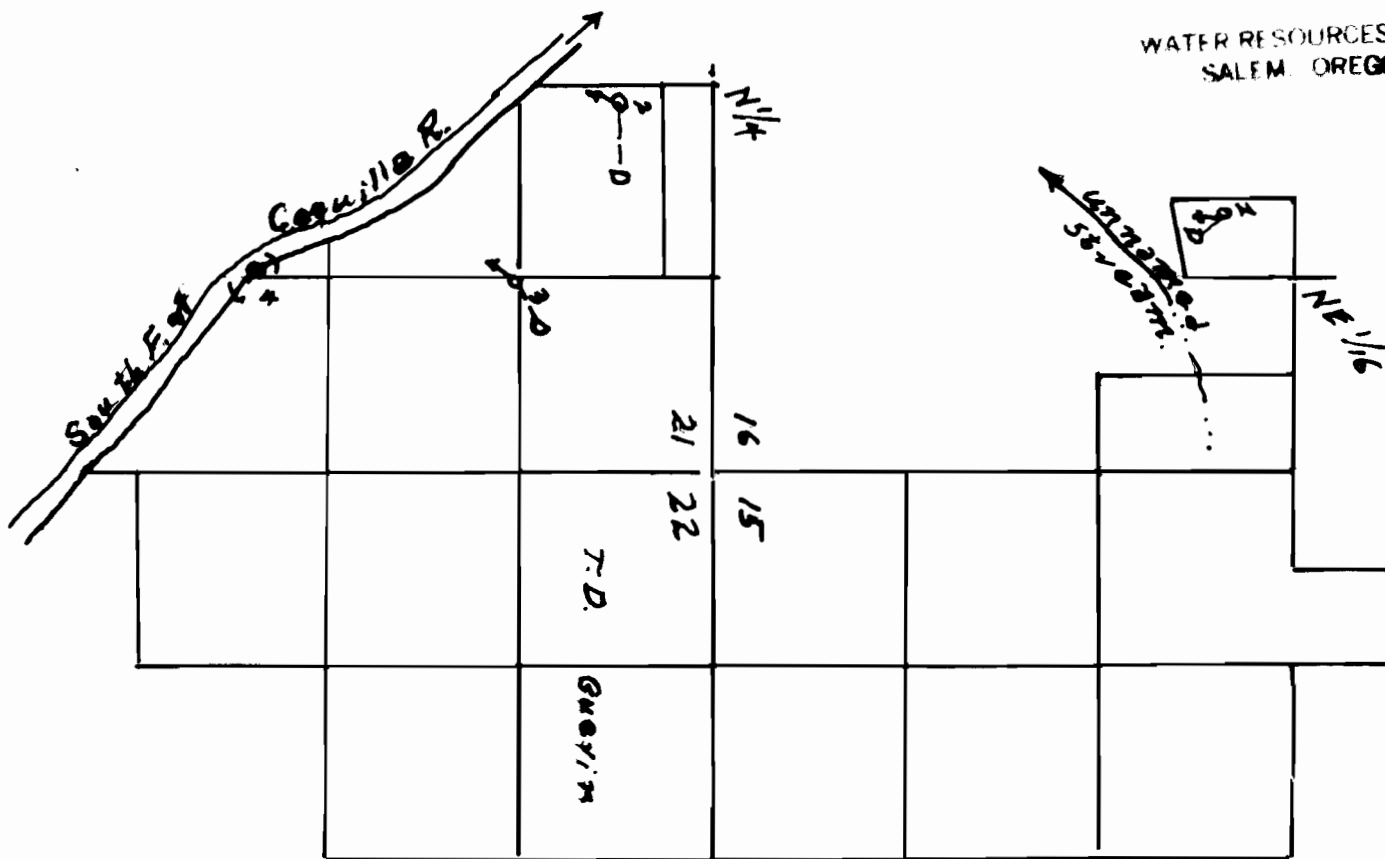

PDD 1 is 507ft S. + 444ft W. of NE 1/6 S. 16.

PDD 2 is 594ft S + 91ft E of N 1/4 S. 21

PDD 3 is 1319ft S. + 1275ft E. of N 1/4 S. 21

PDD 4 is 3125ft S. + 1203ft E. of N 1/4 S. 21

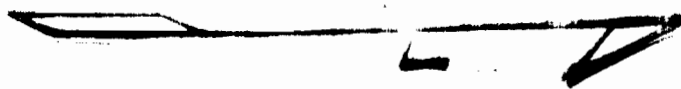
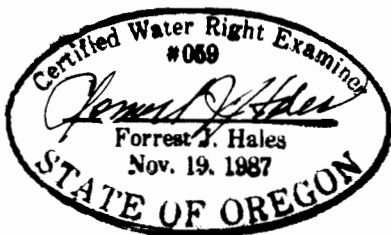

T. 29 S., R. 12 W. W.M. Sec. 14, 15, 22, 23  
 Map for a pre-1909 Surface Water Registration.  
 Scale: 1" = 1320ft. Date of Survey Aug. 1990.  
 OAR 690-14-170-4 ...the map is for the purpose of  
 identifying the location of the water right only.  
 Map 1 of 2 SWR 212

Use: Stock watering for up to 600 A.U. units.  
 See Permit # 2346 for Domestic Use.  
 POD 5 is 157ft N. + 1100' E. of S 1/4 S. 22  
 POD 6 is 370ft S. + 1627ft E. of W. 1/4 S. 23  
 POD 7 is 349ft S. + 423ft E. of N. 1/4 S. 23

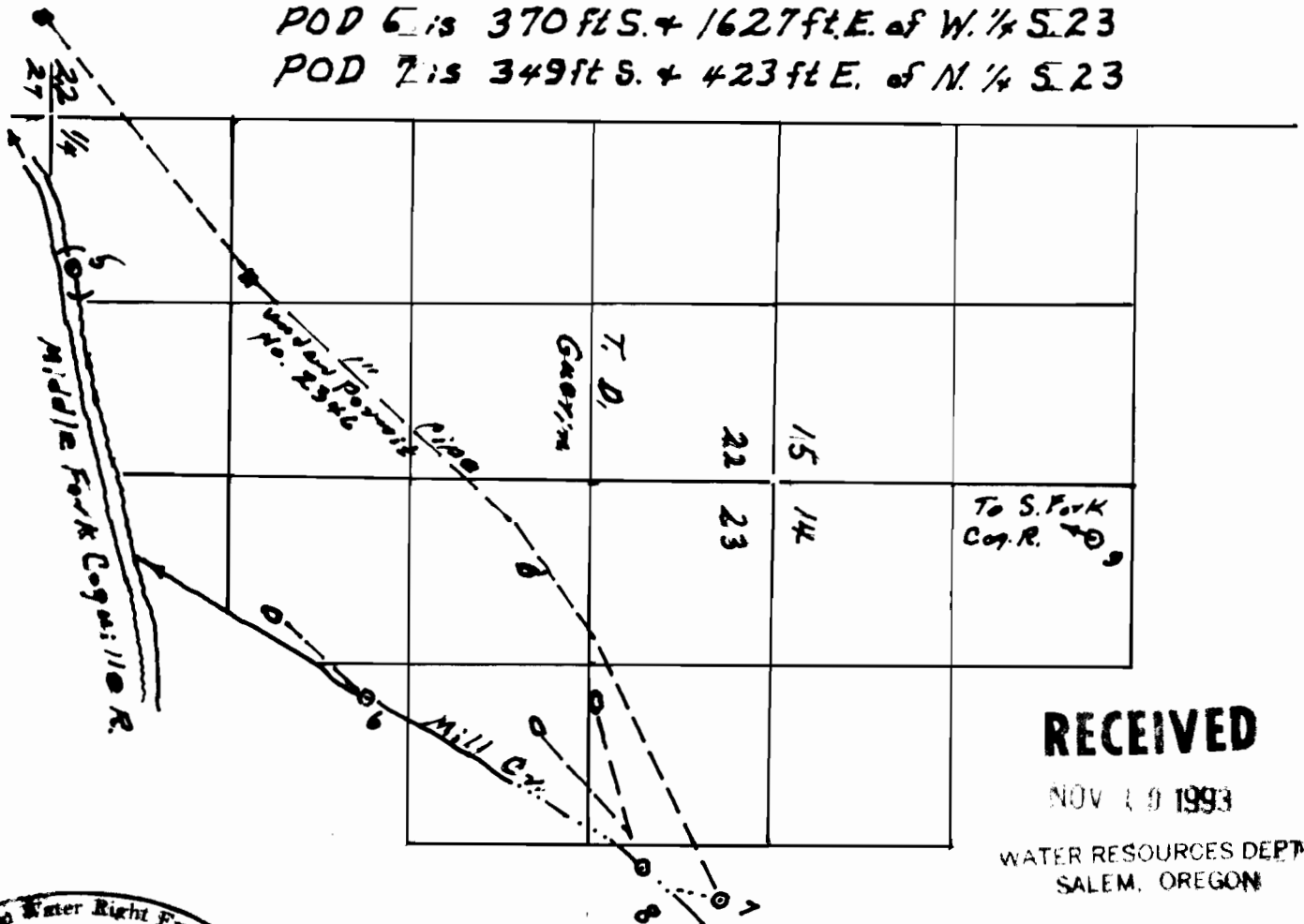

**RECEIVED**

NOV 19 1993

WATER RESOURCES DEPT.  
 SALEM, OREGON



POD 8 is 770' S. + 230' E. of N 1/4 S. 23.  
 POD 9 is 321' S. + 890' W. of NE cor. NW 1/4 SW 1/4 S. 14.

