

RECEIVED

DEC 21 1987  
WATER DIVISION  
SALEM, OREGON

# SURFACE WATER REGISTRATION MAP

for

## W.C. ALBRO LIVING TRUST

### TOWNSHIP 22 SOUTH, RANGE 8 WEST, W.M. SECTIONS 5 & 8

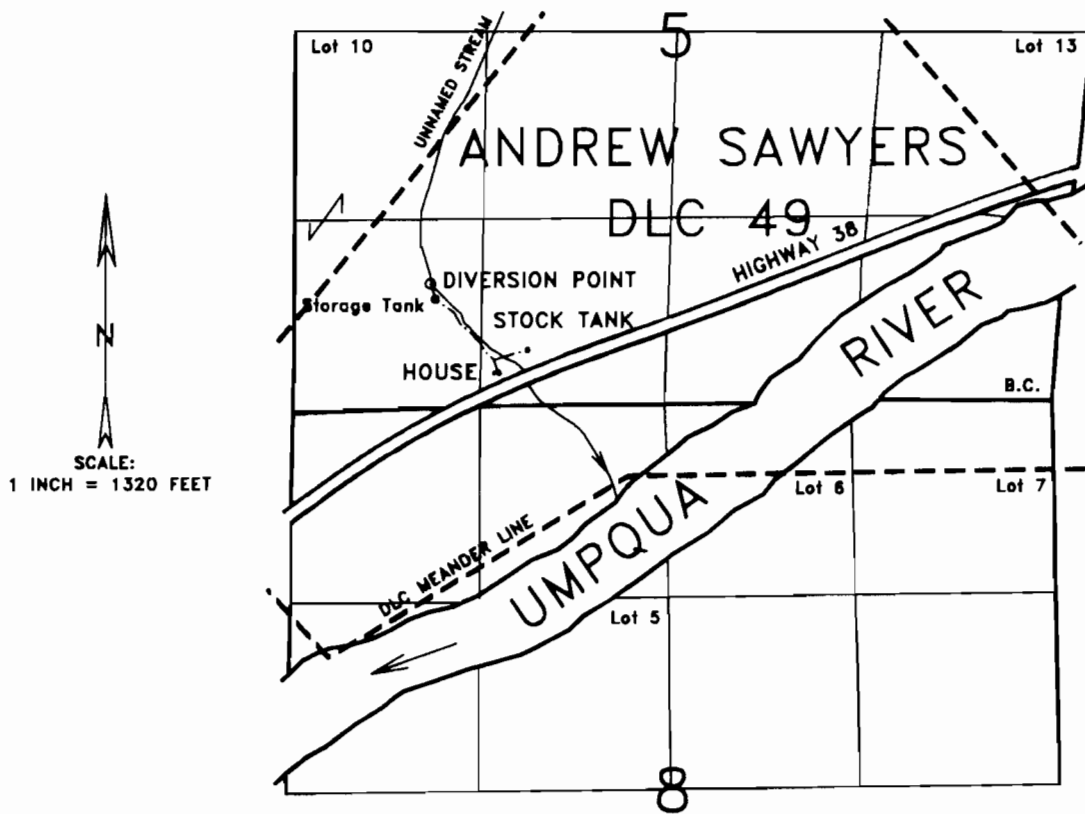

THE DIVERSION POINT IS LOCATED 800 FEET NORTH AND 4300 FEET WEST FROM THE SOUTHEAST CORNER OF SECTION 5.

THE PURPOSE OF THIS MAP IS TO IDENTIFY THE LOCATION OF THE WATER RIGHT. IT IS NOT INTENDED TO PROVIDE INFORMATION RELATIVE TO THE LOCATION OF PROPERTY OWNERSHIP BOUNDARY LINES.

