



REGISTRATION STATEMENT MAP

IN THE NAME OF SAMUEL W. LEE

1 INCH = 1320 FEET

SECTION 11, TOWNSHIP 26 SOUTH, RANGE 5 WEST, W.M.

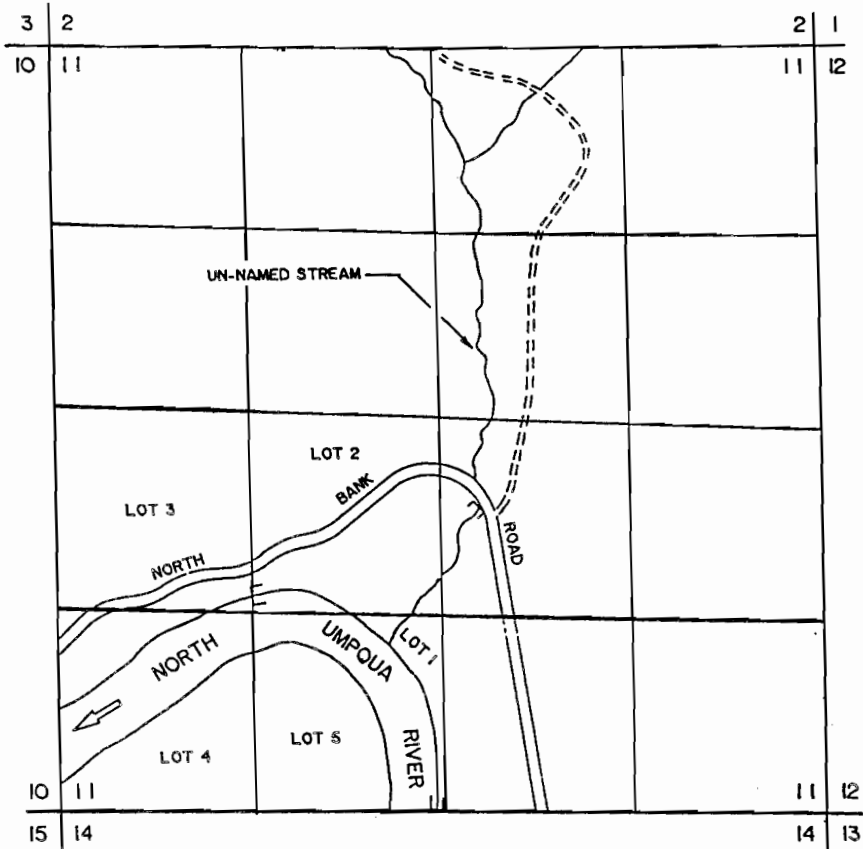

[] STOCKWATERING LIMITS

THE PURPOSE OF THIS MAP IS TO IDENTIFY THE LOCATION OF THE WATER RIGHT. IT IS NOT INTENDED TO PROVIDE INFORMATION RELATIVE TO THE LOCATION OF PROPERTY OWNERSHIP BOUNDARY LINES.

