

# PRE- 1909 VESTED WATER RIGHTS APPLICATION MAP

LOCATED IN SECTION 16 AND 21, T. 24S., R. 12W., W.M., COOS COUNTY, OREGON

SCALE 1" = 1320'

DATE SURVEYED: 12/25/92

FOR: ALFRED GROSSEN

BENEFICIAL USE: IN-STREAM STOCKWATER (SHOWN THUS  (INCLUSIVE) )

CLAIM BASED ON 60 BEEF CATTLE AT 15 GAL./DAY USE

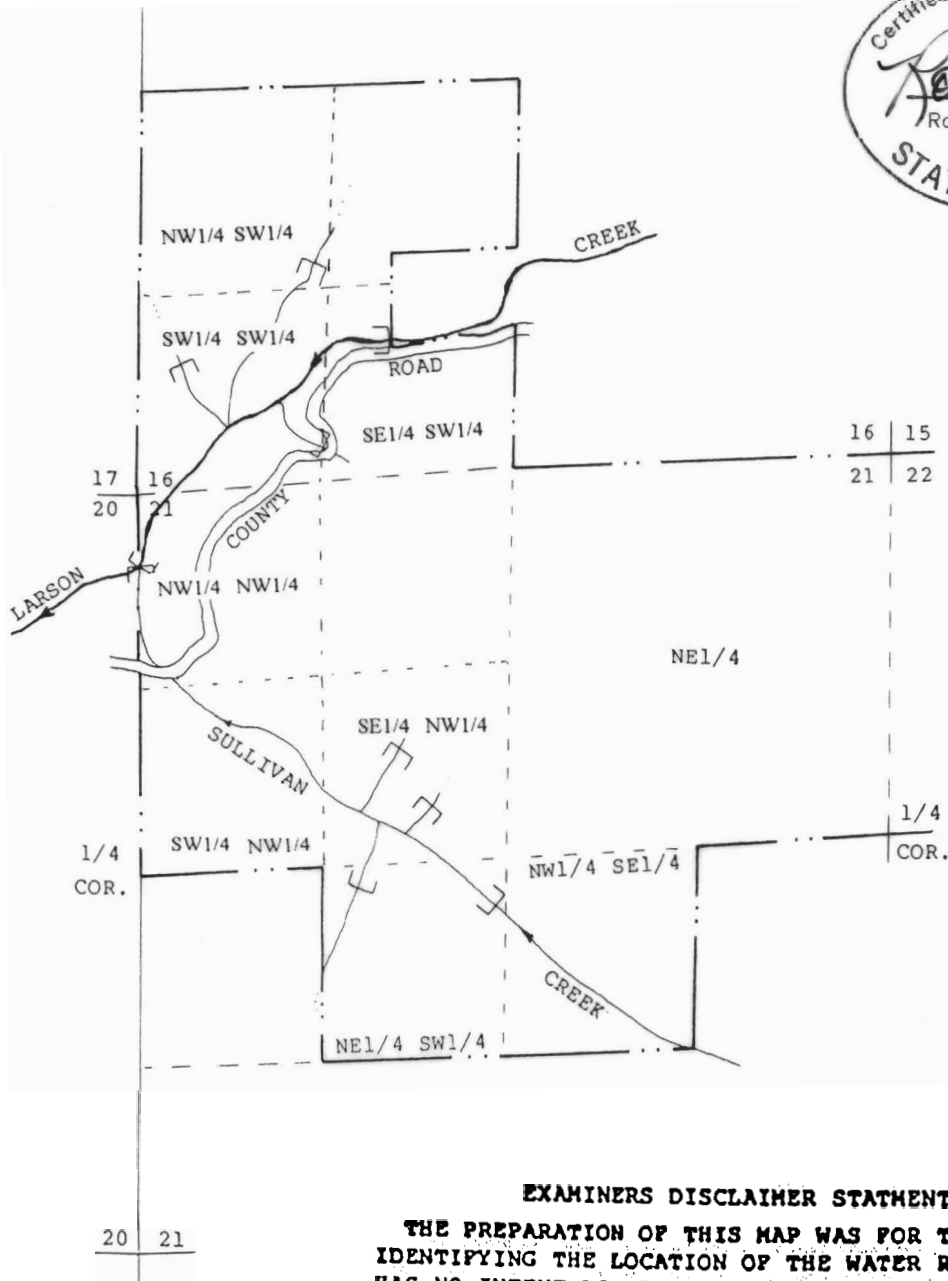
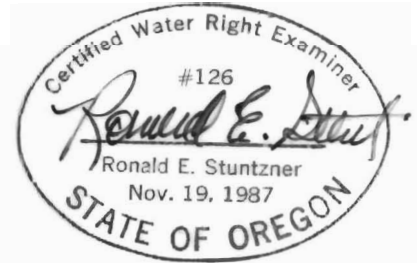
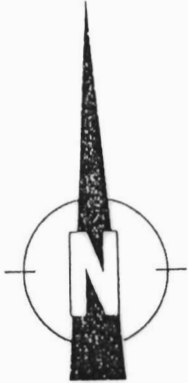

**RECEIVED**  
OCT 08 1993  
WATER RESOURCES DEPT.  
SALEM, OREGON